



suresmile®

elemetri^{ix}

Conference 2018

FORT WORTH, TEXAS | FEBRUARY 22-24

Conference at a Glance

Who: suresmile & elemetrix Doctors and Staff

What: 2018 suresmile | elemetrix Conference

When: February 22-24, 2018

Where: The Worthington Renaissance Fort Worth Hotel in Fort Worth, Texas

Glimpse of Agenda

Ω Thursday evening, February 22nd - Welcome Reception

Ω Friday & Saturday, February 23rd - 24th - Breakout sessions throughout the day

Ω Friday evening, February 23rd - Dinner and boot scootin' dancin' at Billy Bob's Texas - World's largest honky-tonk

Ω Sunday, February 25th - Check out and head home

Invitation to Exhibit

You are invited to join an exclusive list of business partners at our biennial conference scheduled February 22-24, 2018 at The Worthington Renaissance Fort Worth Hotel in Fort Worth, Texas. Our conference format expands your opportunities to meet and interact with suresmile | elemetrix doctors and their staff.

Why you can't miss this event...

Strong attendance – we are expecting more than 125 doctors and 350 of their team members to attend. Upon the release of our agenda preview and program speakers, the already rapidly growing number of registrants continue to increase.

Focused event - our exclusive invitation list for exhibitors generates synergy between suresmile users and your supporting products/services.

Central location for conference and exhibits - you will have frequent opportunities to meet with attendees during breaks and the Welcome Reception located in the exhibit area.

Energizing meeting theme – a special theme for the meeting and dinner party will create the most energizing conference atmosphere yet in which to build customer relationships.

Active participation levels – this year, we are offering three levels of participation to exhibitors to allow you to choose the package that best fits your product or service.

There's no way to really mock up or simulate what I'm doing until I'm there. An exhibition for me is not a statement but an experiment.

Robert Irwin

PARTICIPATION LEVELS

Bronze Level

\$2,995

- One (1) registration* providing access to all conference meals, sessions and the dinner party
- Company logo on the conference website and program

NOTE: The bronze participation level does not include an exhibit space

Silver Level

\$3,395

The Silver package includes the benefits listed above for the Bronze level, PLUS:

- One (1) additional registration (2 total) * providing access to all conference meals, sessions and the dinner party
- Dedicated 6' draped table in exhibit area with 2 chairs
- Your company name/logo listed in our exhibitor passport and prizes to drive traffic to your space
- Company logo and up to 50-word description on the conference website and program
- Access to post-conference attendee list

Gold Level

\$3,995

The Gold package includes the benefits listed above for the Silver level, PLUS:

- One (1) additional registration (3 total) * providing access to all conference meals, sessions and dinner party
- One (1) opportunity to speak at a 20-minute Breakout Session. *Breakout Session slots are limited for Gold Level registrants (first-come, first-choice basis. Not all Gold Level will be able to have a Breakout Session) Name of speaker must be submitted during the development period of the program. Must present a topic and presentation no later than one month after registration. Presentation must be free of commercial bias, and final approval is the right of suresmile | elemetrix Conference.*
- Welcome reception sponsorship signage
- Dedicated "premium located" exhibit table
- Company logo and hyperlink on conference email blasts

**Register additional representatives for \$395 each*

In addition to these exhibitor packages, we're opening up additional sponsorship opportunities in our event mobile app that all attendees will have access to before and during the conference. Stay tuned for more details about how you can get more exposure with our event mobile app.



FREQUENTLY ASKED QUESTIONS

Who do you expect to attend the 2018 suresmile | elemetrix Conference?

We estimate total attendance of approximately 125 new and experienced orthodontists and 350 of their team members. We will provide an attendee list that includes names and email addresses by January 30th, 2018. The list of actual attendees can be provided just after the event.

Note: Attendees may opt out of the list during conference registration.

What does the registration fee include?

See **Participation Level** for details. What's included in the registration fee depends on which level you registered as.

What are the guidelines for shipment of my exhibit materials?

To have your exhibit materials shipped to and from the hotel will incur **Shipping/Receiving Service Charges**. Items should not arrive before February 19, 2018.

For a detailed list of charges and any questions pertaining to the receiving or shipping out of packages please contact the

Conference Help Desk

info@suresmileevents.com

1-855-661-6422

Additional Hotel Shipping Address:

The Worthington Renaissance
200 Main Street
Fort Worth, Texas 76102

Where is my table?

You will be notified of table assignments by January 29, 2018.

Can we choose our table space?

We will assign space based on the order & level of registration and product type.

During registration, you may type a note to indicate vendors who you prefer to be in close proximity or not. We will try to accommodate your request, if possible.

Can I make appointments with doctors during the symposium?

You may conduct appointments during meals, breaks and before the educational sessions begin or after they end.

Where can I obtain internet, equipment or electrical services for my exhibit?

When you register for the conference, you will receive a confirmation email that will contain a form from the hotel that you can fill out and submit to the hotel for obtaining internet, equipment or electrical services for your exhibit.

Can I provide a giveaway for the attendee registration bags?

You may provide a promotional item for the registration bags.

We are expecting approximately 125 doctors and 350 team members to attend the meeting. Note: we cannot accept handouts or other paper collateral.

If you are interested in providing a giveaway, enter information about your promotional item during registration.

Are there other sponsorship and advertising opportunities?

Several opportunities are available to increase awareness of your brand. These items would be purchased and shipped by the sponsor. Reminder that items cannot arrive before February 19, 2018.

Can I bring a popup display?

Yes. You will be provided a 6-foot table for your exhibit so please ensure your popup display is no larger than your table.

What is the Cancellation policy?

Please contact us at Email: info@suresmileevents.com or call toll-free: 1-855-661-6422 to process your cancellation. Cancellation due dates are:

Refund	If Canceled By
90%	Thursday, August 31, 2017
70%	Tuesday, October 31, 2017
45%	Sunday, December 31, 2017
20%	Saturday, February 3, 2018
0%	Sunday, February 4, 2018

Hold Harmless Clause

The exhibitor assumes the entire responsibility and liability for losses, damages, and claims arising out of exhibitor's activities on the Hotel premises and will indemnify, defend, and hold harmless the Hotel, its owner, and its management company, as well as their respective agents, servants, and employees from any and all such losses, damages, and claims.

EXHIBIT HALL

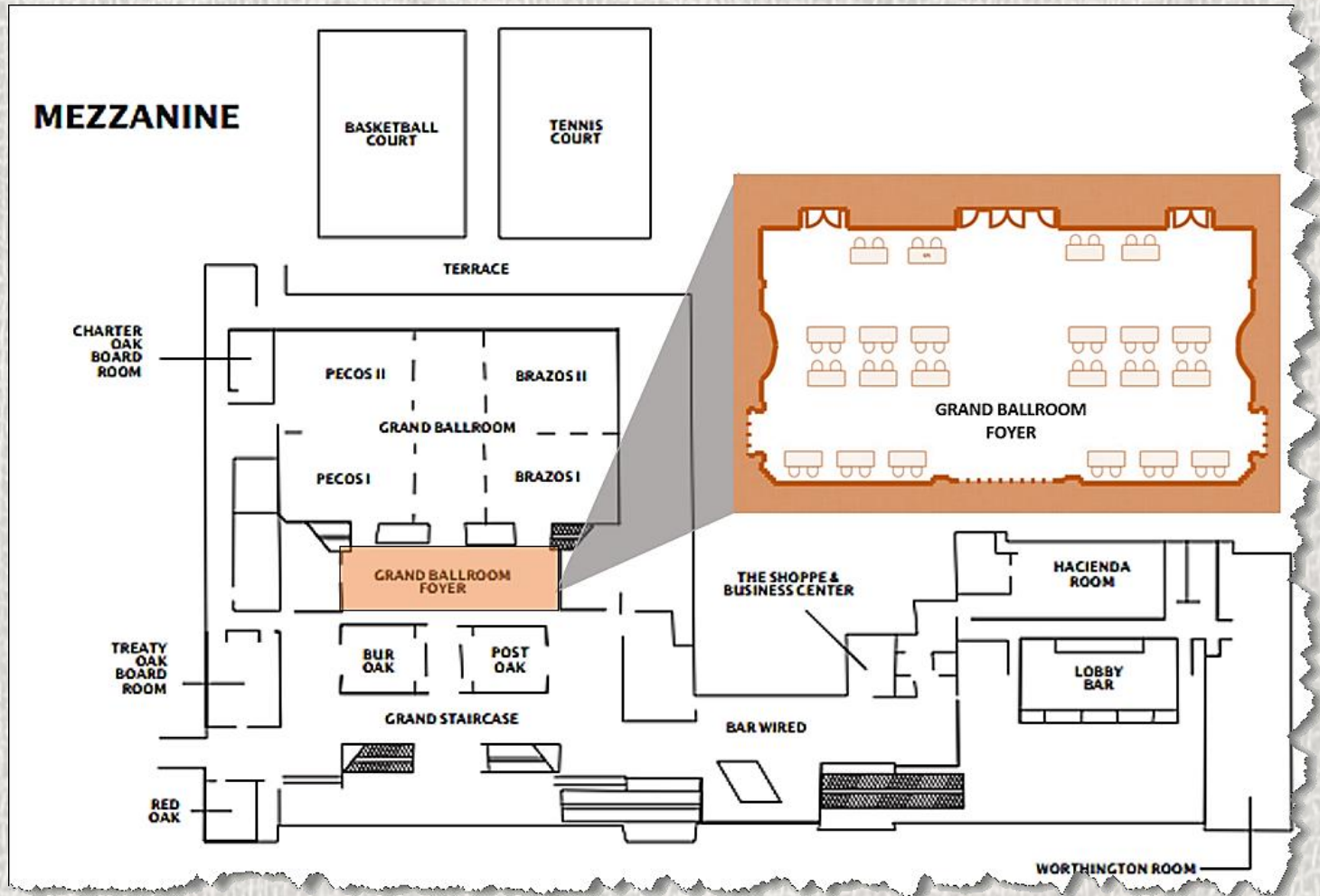

We're here for you...

If you have additional questions,
please contact us:

Conference Help Desk

info@suresmileevents.com

1-855-661-6422