

BSC 2018

37TH ANNUAL CONGRESS



Modern cardiology in the picture

PROGRAMME

BRUSSELS
8-9
FEBRUARY
2018

SQUARE
Mont des Arts
B-1000
Brussels

ORGANISING COMMITTEE



c/o Mrs. Yolanda Thornton
BSC Secretariat
Tel +32 (0)2 644 62 32
Email bsc@bscardio.be



Member National
Cardiac Society



SCIENTIFIC COMMITTEE

Prof. Marc Claeys
UZ Antwerpen

Prof. Patricio Lancellotti
CHU Liège

Dr. Peter Geelen
OLV Ziekenhuis Aalst

Prof. Agnès Pasquet
UCL Brussels

Prof. Walter Desmet
UZ Leuven

Dr. Yves Vandekerckhove
AZ Sint-Jan Bruges

Dr. Lieven Herbots
Jessa Ziekenhuis Hasselt

Dr. Pierre Troisfontaines
CHR Citadelle Hospital Liège

Dr. Raymond Kacenenelbogen
CHU Saint-Pierre Brussels

Dr. Patrick Coussement
AZ Sint-Jan Bruges

Prof. Antoine Bondue
Erasmus Hospital Brussels

Dr. Laura Anghel
CHU Brugmann Brussels

Prof. Steven Droogmans
UZ Brussels

Dr. Frank Cools
AZ Klina Brasschaat

Dr. Georges Mairesse
Cliniques Sud Luxembourg

Prof. Guy Van Camp
OLV Ziekenhuis Aalst

WORD FROM THE PRESIDENT

Dear colleagues, dear friends,

It is my great pleasure as president of the BSC, to welcome you to the 37th Annual Congress of the Belgian Society of Cardiology.

The annual meeting of the BSC is your meeting. It will offer you the opportunity to gather together in central Brussels for 2 days of intensive education and networking and meet renowned experts in their specialities.

The overall theme of this edition is: **“Modern cardiology in the picture”**

Cardiology is pre-eminently a discipline with ongoing scientific and technological discoveries resulting in new diagnostic and therapeutic paradigms, which need to be implemented in daily practise. In addition, our way of working will undergo profound changes in view of the pending legislation on hospital networking.

The congress programme will cover all different aspects of modern cardiology and we will introduce some new formats such as the audience voting system, speakers corner, the clash of the Titans in order to increase the interactivity between the audience and the experts.

What can you expect in the 37th edition of the BSC Congress:

- Dedicated BSC Working Group sessions, with best abstract presentations highlighting new information of the different cardiac subspecialities.
- The ESC-BSC joint session will not only present but also challenge the new guidelines on valvular heart disease.
- The College of Cardiology will present an update of quality handbook with focus on heart failure clinics.
- Socio-economical sessions will cover organisational aspects of the cardiology profession.

- Laureate lectures and awards ceremony; Best Poster, Young Investigator, Leon Dumont prize, Jacqueline Bernheim prize, the new Belgian research prize.
- Industry-supported satellite symposia will give the floor to high-level international speakers, presenting different cardiologic topics.
- The final session, the “clash of the Titans”, will be a lively knowledge competition between teams and the audience.

We design this annual meeting to meet your expectations and be a source of new scientific and educational discoveries, allowing for continuous investments in the care of patients with cardiovascular problems, still the number one killer in the Western world.

The BSC congress is “the place to be” on 8th and 9th February 2018!

With enthusiastic and kind regards,



Prof Dr Marc Claeys, MD, PhD
President of the Belgian Society of Cardiology



PROGRAMME AT A GLANCE
THURSDAY 8TH FEBRUARY 2018

COPPER HALL

SILVER HALL

08:00 - 09:00	Registration & welcome coffee	
09:00 - 10:30	Session 1: Cutting edge percutaneous valve intervention Belgian Working Group on Interventional Cardiology (BWGIC)	Session 2: Triple trouble: a patient with AF, coronary artery disease and diabetes. What is the evidence base? Satellite Symposium organised by Boehringer Ingelheim
10:30 - 11:00	Coffee Break & Best Poster Competition (Magritte Foyer) - SPEAKER CORNER "Meet the expert"	
11:00 - 11:45	Session 3: Keynote Session "Modern Cardiology in the picture"	
11:45 - 13:15	Session 4: New advances in endocarditis Working Group Session by the Young Cardiologists Club (YCC)	Session 5: Diagnosing and treatment of AF in the Real World Satellite Symposium organised by BMS/Pfizer
13:15 - 14:15	Lunch - SPEAKER CORNER "Meet the expert"	Lunch Session: Genetic diseases in cardiology - approach in your daily practice Satellite Symposium organised by Sanofi
14:15 - 15:45	Session 6: Heart failure and the management of the Co-morbidities Belgian Working Group on Heart Failure (BWGHF) in collaboration with the Cardiovascular Nursing working group (BWGCVN)	Session 7: Cold case: cardiovascular disease progression - who is responsible and how to treat? Satellite Symposium organised by Servier
15:45 - 16:15	Coffee Break - SPEAKER CORNER "Meet the expert" (Silver Foyer)	
16:15 - 17:45	Session 8 - Leadless Pacing Working Group Session by the Belgian Heart Rhythm Association (BeHRA)	Session 9 - Multimodality Imaging in Cardiomyopathies Working Group Session by the Belgian Working Group on Non-invasive Cardiac Imaging (BWGNICI)
17:45 - 18:30	Networking Cocktail Event - with DCTrio: Jazzy Cardiology - SPEAKER CORNER "Meet the expert"	

FRIDAY 9TH FEBRUARY 2018

COPPER HALL

SILVER HALL

08:00 - 09:00	Registration & welcome coffee	
09:00 - 10:30	Session 10: Cardiac rehabilitation: are we getting better? Working Group Session by the Belgian Working Group on Cardiovascular Prevention and Rehabilitation (BWGCPR)	Session 11: Challenging the STEMI guidelines Working Group Session by the Belgian Interdisciplinary Working Group on Acute Cardiology (BIWAC)
10:30 - 11:00	Coffee Break & BSC and Acta Cardiologica General Assembly (Copper Hall) - SPEAKER CORNER "Meet the expert"	
11:00 - 11:45	Session 12: Young Investigator Award Presentations	11:00 - 12:30 Session 13: Engaging with NOACs: Treating challenging patients without surprise Satellite Symposium organised by Daiichi Sankyo
11:45 - 13:15	Session 14: BSC-ESC joint session on evidence based medicine in cardiology. Quality assessment of cardiac care in Belgium + Awards Ceremony	12:30 - 13:00 Session 15: Dr. Léon Dumont prize & Jacqueline Bernheim prize laureate lectures
13:15 - 14:15	Lunch SPEAKER CORNER "Meet the expert"	Lunch Session: Heart failure management: a step into the future Satellite Symposium organised by Abbott
14:15 - 15:45	Session 16: Septal defects: mind the gap! Working Group Session by the Belgian Working Group on Adult Congenital Heart Disease (BWGACHD)	Session 17: From the new ESC guidelines to clinical practice: interactive case presentations of high risk MI patients with multiple comorbidities Satellite Symposium organised by AstraZeneca
15:45 - 16:00	Coffee Break - SPEAKER CORNER "Meet the expert" (Silver Foyer)	
16:00 - 17:00	Session 18: Closing event "Clash of the Titans" An interactive engaging session with audience participation, for all cardiologists addressing actual needs and possible gaps in knowledge	



PRELIMINARY PROGRAMME
THURSDAY 8TH FEBRUARY 2018

COPPER HALL

08:00 - 09:00 Registration & welcome coffee

09:00 - 10:30 **Session 1: Cutting edge percutaneous valve intervention**
Working Group Session by Interventional Cardiology (BWGIC)

Moderators:

Joëlle Kefer - UCL Brussels, BE
Christophe Dubois - UZ Leuven, BE

TAVI: recent and future evolutions in technique and materials

Johan Bosmans - UZ Antwerpen, BE

Off-label use of TAVI-and MitraClip-devices

Bernard De Bruyne - OLV Aalst, BE

Percutaneous mitral valve replacement: ready for prime time?

Sonia Petronio - University of Pisa, IT

Best abstract presentation

6 years follow-up of Fractional Flow Reserve-guided versus angiography-guided Coronary Artery Bypass Graft surgery

Stéphane Fournier - OLV Hospital Aalst, BE

10:30 - 11:00 Coffee break & **Best Poster Competition** (Magritte Foyer)
SPEAKER CORNER "Meet the expert" - Sonia Petronio - University of Pisa, IT

11:00 - 11:45 **Session 3: Keynote session - Modern cardiology in the picture**

Moderators:

Marc Claeys - UZ Antwerp, BE
Patrizio Lancellotti - CHU Sart Tilman Liège, BE

Word of the President

Marc Claeys - UZ Antwerp, BE

**Hospital networking, start of a new organisation for care delivery?
Perspective for the future in Belgium**

Marc Geboers - Zorgnet-Icuro Brussels, BE

SILVER HALL

09:00 - 10:30 **Session 2: Triple trouble: a patient with AF, coronary artery disease and diabetes. What is the evidence base?**
Satellite Symposium organised by Boehringer Ingelheim

Moderators:

Guy Van Camp - OLV Aalst, BE
Philippe van de Borne - Erasmus Hospital Brussels, BE

Introduction

Guy Van Camp - OLV Aalst, BE

Double trouble: Antithrombotic strategies post-PC I in AF patients: How to incorporate the new evidence in our practice?

J. Oldgren - Uppsala University Hospital, SE

Cardiovascular disease and type 2 diabetes management in the cardiologist's office: myth or reality?

Philippe van de Borne - Erasmus Hospital Brussels, BE

In times of trouble: management of urgent CV procedures in anticoagulated patients

Thomas Vanassche - UZ Leuven, BE

Q&A

Philippe van de Borne - Erasmus Hospital Brussels, BE



PRELIMINARY PROGRAMME
THURSDAY 8TH FEBRUARY 2018

COPPER HALL

11:45 - 13:15 **Session 4: New advances in endocarditis**
Working Group Session by the Young Cardiologist Club (YCC)

Moderators:

Laura Anghel - CHU Brugmann Brussels, BE
Steven Droogmans - UZ Brussels, BE

Multi-modality imaging in 2018

Fabien Hyafil - Hôpital Bichat Paris, FR

Innovations in endocarditis treatment

Thomas Vanassche - KUL Leuven, BE

Best abstract presentation

Improvement in FFR predicts 2-year outcome after PCI.

A FAME 1 & FAME 2 Sub-Analysis

Stéphane Fournier - OLV Hospital Aalst, BE

13:15 - 14:15 Lunch
SPEAKER CORNER "Meet the expert"
Stefan Hohnloser - J. W. Goethe University, Frankfurt, DE



SILVER HALL

11:45 - 13:15 **Session 5: Diagnosing and treatment of AF in the Real World**
Satellite Symposium organised by BMS/Pfizer

Moderators:

Hein Heidbuchel - UZ Antwerp, BE
Georges Mairesse - Vivalia Clinique St Joseph, Arlon, BE

Welcome and Introduction

Hein Heidbuchel - UZ Antwerp, BE

AF Screening and Awareness

Georges Mairesse - Vivalia Clinique St Joseph, Arlon, BE

NOACs during cardioversion and pulmonary vein ablation: evidence and optimal management

Hein Heidbuchel - UZ Antwerp, BE

Emerging Real World Data on anticoagulation in stroke prevention after NVAF: can you still see the wood for the trees?

Stefan Hohnloser - J. W. Goethe University, Frankfurt, DE

Panel discussion

Moderated by Hein Heidbuchel - UZ Antwerp, BE

13:15 - 14:15 **Lunch time session:**
Genetic diseases in cardiology - approach in your daily practice
Satellite Symposium organised by Sanofi
(lunch available in the room)

Moderators:

Antoine Bondue - Erasmus Hospital Brussels, BE
Julie De Backer - UZ Ghent, BE

The cardiologist facing rare diseases in clinical practice : be aware !

Perry Elliott - University College London, UK

Emerging therapies for hereditary cardiomyopathies

Ales Linhart - University Hospital Prague, CZ

Panel discussion

PRELIMINARY PROGRAMME
THURSDAY 8TH FEBRUARY 2018

COPPER HALL

14:15 - 15:45 **Session 6: Heart failure and the management of the Co-morbidities**
Belgian Working Group on Heart Failure (BWGHF) in collaboration with the
Nursing working group (BWGCVN)

Moderators:

Walter Droogne - UZ Leuven, BE
Pierre Troisfontaines - CHR Liège, BE

Heart Failure nurses: Their added value in the management of HF and the comorbidities

Anna Strömberg - Linköpings University, SE

Sleep Disorders

Michel De Pauw - UZ Ghent, BE

Diabetes

Olivier Gurné - UCL Brussels, BE

Lung disease and pulmonary hypertension

Jean-Luc Vachery - Erasmus Hospital Brussels, ULB Brussels, BE

Cardio-renal interaction

Wilfried Mullens - ZOL Genk, BE

Best abstract presentation

**Conservative and Invasive Treatment in Hypertrophic Obstructive
Cardiomyopathy: Long-term Outcome**

Sarah Hoedemakers - Brussels University Hospital, BE

15:45 - 16:15 Coffee break
SPEAKER CORNER "Meet the expert" - Stefano Taddei - University of Pisa, IT



SILVER HALL

14:15 - 15:45 **Session 7: Cold case: cardiovascular disease progression - who is responsible and how to treat?**
Satellite Symposium organised by Servier

Moderators:

Raymond Kacenenbogen - CHU St Pierre Brussels, BE
Johan De Sutter - UZ Ghent, BE

The endothelium and atherosclerosis in the cardiovascular continuum

Stefano Taddei - University of Pisa, IT

How to break the cardiovascular continuum: view of the lipidologist

Olivier Descamps - UCL Brussels, BE

How to break the cardiovascular continuum: view of the cardiologist

Peter Sinnaeve - UZ Leuven, BE

PRELIMINARY PROGRAMME
THURSDAY 8TH FEBRUARY 2018

COPPER HALL

- 16:15 - 17:45** **Session 8: Leadless Pacing**
Working Group Session by the Belgian Heart Rhythm Association (BeHRA)
- Moderators:**
Ivan Blankoff - CHU Charleroi, BE
Yves Vandekerckhove - AZ Sint Jan Bruges, BE
- The future of leadless pacing**
Clemens Steinwender - Kepler University Hospital Linz, Austria
- The Belgian experience with leadless pacing**
Christophe Garweg - UZ Leuven, BE
- Best abstract presentation**
Burden of atrial ectopy after pulmonary vein isolation is a predictor of success
Pieter Koopman - Heart Center Hasselt, Jessa Hospital, BE
- 17:45 - 18:30** Networking Cocktail event with DC Trio: Jazzy Cardiology
SPEAKER CORNER "Meet the expert"
Clemens Steinwender - Kepler University Hospital Linz, Austria



SILVER HALL

- 16:15 - 17:45** **Session 9: Multimodality Imaging in Cardiomyopathies**
Working Group Session by the Belgian Working Group on Non-invasive Cardiac Imaging (BWGNICI)
- Moderators:**
Lieven Herbots - Jessa Ziekenhuis Hasselt, BE
Bernard Cosyns - UZ Brussels, BE
- Restrictive CMP**
Gilbert Habib - La Timone Hospital, Marseille, FR
- Hypertrophic CMP**
Chiara Buccianelli - Ducci - Bristol University, UK
- How does imaging change your decision in Ischemic CMP?**
Guy Van Camp - OLV Ziekenhuis Aalst, BE
- Best abstract presentation**
Effects of sildenafil on pulmonary vascular and right ventricular contractile reserve in chronic thromboembolic disease: an exercise cardiac magnetic resonance study.
Mathias Claeys - UZ Leuven, BE



PRELIMINARY PROGRAMME
FRIDAY 9TH FEBRUARY 2018

COPPER HALL

08:00 - 09:00 Registration & welcome coffee

09:00 - 10:30 Session 10: Cardiac rehabilitation: are we getting better?

Working Group Session by the Belgian Working Group on Cardiovascular Prevention and Rehabilitation (BWGCPR)

Moderator:

Raymond Kacenenbogen - CHU St Pierre Brussels, BE
Marie-Christine Iliou - G. Pompidou Hospital Paris, FR

The efficacy of CR in the contemporary era of optimal acute revascularization and evidence-based pharmacotherapy: results from the CROS study

Costas Davos - Biomedical Research Foundation Academy of Athens, GR

Patient-tailored exercise prescription, the EXPERT tool

Marie-Christine Iliou - G. Pompidou Hospital Paris, FR

Innovative care delivery strategies for Cardiac Rehabilitation

Ines Frederix - UHasselt, BE

Best abstract presentation

Efficacy of Anti-PCSK9 in Familial Hypercholesterolaemia in a real-life study

Charlotte de Fays - Centres Hospitaliers Jolimont, BE

10:30 - 11:00 Coffee break **BSC & Acta Cardiologica General Assembly**
SPEAKER CORNER "Meet the expert" - Stefan James - Uppsala University, SE

SILVER HALL

09:00 - 10:30 Session 11: Challenging the STEMI guidelines

Working Group Session by the Belgian Interdisciplinary Working Group on Acute Cardiology (BIWAC)

Moderators:

Patrick Coussement - AZ St Jan Brugge, BE
Suzanne Pourbaix - CHR Liège, BE

Top ten messages from the 2017 ESC STEMI guidelines

Stefan James - Uppsala University, SE

Ten years STEMI registry in Belgium

Marc Claeys - UZ Antwerp, BE

Challenging the guidelines: a patient with STEMI and cardiogenic shock

Stijn Lochy - UZ Brussel, BE

How to manage gaps in evidence in STEMI

Christophe Beauloye - UCL Brussels, BE

Panel discussion

Best abstract presentation

Role of fibroblastic AMPK δ 1 in left ventricular remodeling after myocardial infarction

Cecile Dufey - UCLouvain, BE



PRELIMINARY PROGRAMME
FRIDAY 9TH FEBRUARY 2018

COPPER HALL

11:00 - 11:45 Session 12: Young Investigator Award presentations

Moderator/jury:

Marie-Christine Iliou - G. Pompidou Hospital Paris, FR
Christophe Beauloye - UCL St Luc, BE

Best YIA Abstracts presentations

Nicotine free high output wattage electronic cigarettes vaping: lung toxicity but cardiovascular safety?

Martin Chaumont - Erasme Hospital, BE

Endothelial Senescence Contributes to Heart Failure With Preserved Ejection Fraction in an Aging Mouse Model

Andreas B. Gevaert - University of Antwerpen, BE

Von Willebrand Factor: at the heart of Staphylococcus aureus and Staphylococcus lugdunensis endocarditis

Laurens Liesenborghs - KU Leuven, BE

11:45 - 13:15 Session 14: BSC-ESC joint session on evidence based medicine in cardiology. Quality assessment of cardiac care in Belgium

Moderators:

Marc Claeys - UZ Antwerp, BE
Agnès Pasquet - UCL Brussels, BE

Quality handbooks: Footprint of current practice in Belgium: focus on heart failure clinics

David Raes - GZA ziekenhuis Wilrijk, BE

Case based challenge of the guidelines on Valvular Heart Disease

Helmut Baumgartner - University of Muenster, DE

Awards Ceremony:

BSC Best Poster, Young Investigator Award, Dr Léon Dumont prize, Jacqueline Bernheim prize, BSC Research Grant

SILVER HALL

11:00 - 12:30 Session 13: Engaging with NOACs: Treating challenging patients without surprise?

Satellite Symposium organised by Daiichi Sankyo

Moderators:

Frank Cools - AZ KLINIA Brasschaat, BE
Patrizio Lancellotti - CHU Sart Tilman Liège, BE

NOACs: from Birth to Bedside

Michele Mercuri - DS Pharma Development Basking Ridge, US

Treating challenging patients: pulmonary embolism

Peter Verhamme - UZ Leuven, BE

Treating challenging patients: the renal impaired

Felicità Andreotti - Catholic University Roma, IT

Treating challenging patients: the elderly patient

Jan Steffel - University Heart Center Zurich, CH

12:30 - 13:00 Session 15: Dr. Léon Dumont prize and Jacqueline Bernheim prize laureate presentation

Dr Léon Dumont prize laureate

Developing strategies for precision medicine in heritable thoracic Aortic Disease

Julie De Backer - Ghent University Hospital, BE

2017 Jacqueline Bernheim prize laureate

Secondary mitral valve regurgitation: hemodynamic and numerical insights towards a patient tailored approach

Philippe Bertrand - Jessa Ziekenhuis Hasselt, BE



COPPER HALL

13:15 - 14:15 Lunch
SPEAKER CORNER "Meet the expert"
Helmut Baumgartner, University of Muenster, DE

14:15 - 15:45 **Session 16: Septal defects: mind the gap!**
Working Group Session by the Belgian Working Group on Adult Congenital Heart Disease (BWGACHD)

Moderators:
Antoine Bondue - Erasmus Hospital Brussels, BE
Daniel De Wolf - UZ Ghent, BE

The hidden danger : how to not miss, diagnose and assess the gap?
Markus Schwerzman - Hospital Inselspital, Bern, CH

Septal defects, a pitfall for cardiologists: case presentation
Sophie Pierard - UCL Brussels, BE

Pro : Septal defect should be closed : Why ? When ?
Marc Gewillig - UZ Leuven, BE

Con : Septal defect can be tolerated and should not be closed
Marielle Morrissens - CHU Brugmann Brussels, BE

Results from voting and panel discussion
Sophie Pierard - UCL Brussels, BE

Best abstract presentation
Phosphorylation Of Acetyl-coa Carboxylase By Ampk In Platelets Controls Thromboxane Generation, Dense Granules Secretion And Thrombus Formation.
Sophie Lepropre - UCLouvain, BE

SILVER HALL

13:15 - 14:15 **Lunch time Session: Heart Failure management: a step into the future**
Satellite Symposium organised by Abbott
(lunch available in the room)

Moderators:
Matthias Dupont - ZOL Genk, BE
Pierre Troisfontaines - CHR Citadelle Liège, BE

Cardiac resynchronization therapy: How to get the best out of the Device!
Wilfried Mullens - ZOL Genk, BE

Telemonitoring & Continuous pulmonary artery pressure monitoring for the treatment of heart failure
Birgitt Assmus - Universitätsklinikum Frankfurt, DE

14:15 - 15:45 **Session 17: From the new ESC guidelines to clinical practice: interactive case presentations of high risk MI patients with multiple comorbidities**
Satellite Symposium organised by AstraZeneca

Moderators:
Patrick Coussement - AZ Sint-Jan Brugge, BE
Christophe Beauloye - UCL Brussels, BE

Acute and chronic care of an MI patient with chronic kidney disease
Walter Desmet - UZ Leuven, BE

Acute and chronic care of an MI patient with diabetes mellitus
Olivier Gach - CHU Liège, BE



COPPER HALL

15:45 - 16:00 Coffee break - **SPEAKER CORNER "Meet the expert"**
Markus Schwerzman - Hospital Inselspital, Bern, CH

16:00 - 17:00 **Session 18: Closing event "Clash of the titans": Beers versus Wines**
An interactive engaging session with audience participation, for all cardiologists addressing actual needs and possible gaps in knowledge

Moderators:

Patrizio Lancellotti - CHU Liège, BE
Bernard Cosyns - UZ Brussels, BE

Jury:

Marc Claeys - UZ Antwerp, BE
Agnès Pasquet - UCL Brussels, BE
Guy Van Camp - OLV Aalst, BE



ACCREDITATION



"The 37th Annual Congress of the Belgian Society of Cardiology, Brussels, Belgium, 08/02/2018 - 09/02/2018 has been accredited by the European Accreditation Council for Continuing Medical Education (EACCME®) with 12 European CME credits (ECMEC®s). Each medical specialist should claim only those hours of credit that he/she actually spent in the educational activity."

"Through an agreement between the Union Européenne des Médecins Spécialistes and the American Medical Association, physicians may convert EACCME® credits to an equivalent number of AMA PRA Category 1 Credits™. Information on the process to convert EACCME® credit to AMA credit can be found at www.ama-assn.org/education/earn-credit-participation-international-activities."

"Live educational activities, occurring outside of Canada, recognised by the UEMS-EACCME® for ECMEC®s are deemed to be Accredited Group Learning Activities (Section 1) as defined by the Maintenance of Certification Program of the Royal College of Physicians and Surgeons of Canada."



MISSION

The Belgian Heart foundation is a new initiative founded by the BSC and launched at the 2018 BSC Congress. It aims to promote cardiovascular research and education, in order to improve the care and outcome of the patients with cardiovascular diseases. To achieve this goal, prizes, research and educational grants will be awarded.

ACTIVITIES

The Belgian Heart Foundation will organize yearly calls for different prizes and grants. Following awards and grants will be launched, but pending on the income of sponsorship, the number and the content of these can be augmented.

PRIZES:

Young Investigators Award (€6.500)
Best poster award (€1.000)

RESEARCH GRANTS:

Doctor Léon Dumon prize, bi-annual (€40.000)
BSC research grant (€15.000/ €10.000)

EDUCATIONAL GRANTS:

Entrance, Travel and accommodation grants for congresses and events (ESC Congress).

More information on BHF: www.belgianheartfoundation.be



**ALL POSTERS INVITED FOR DIGITAL POSTER DISPLAY
CAN BE FOUND IN THE EXHIBITION
FOYERS MAGRITTE & DELVAUX**
(SEE MAP AT CONGRESS ENTRANCE)

BEST POSTERS

The best poster competition will take place during coffee break on Thursday 8th February 2018 from 10:30 till 11:00 in Magritte Foyer.

POSTERS ON DISPLAY

Note: Best posters are indicated by a * in the list below.

ARRHYTHMIAS/DEVICE

- 1. Transvenous removal of a large fungal vegetation in lead associated endocarditis**
Frank Bracke - Catharina Hospital, BE
- 2. Does cardiac rehabilitation reduce the risk of recurrence of atrial fibrillation or the need for a second ablation after the first ablation?**
Kathleen Hoffbauer - Hasselt University, BE

BASIC SCIENCE

- 1. Cardiovascular autonomic neuropathy in patients with type 1 diabetes mellitus**
Renée De Busser - University of Hasselt, BE, Anika Nys - University of Hasselt, BE
- 2. Glycated proteins in cardiac dysfunction: Big molecules, Huge impact**
Dorien Deluyker - Hasselt University, BE
- 3. Increased Acetyl-CoA carboxylase phosphorylation state in platelets identify high risk patients with coronary artery disease: ACCTHEROMA trial**
Shakeel Kautbally - Université catholique de Louvain / IREC, BE
- 4. Autonomic profile of patients with primary autonomic failure**
N. Loudiyi - IBN SINA Hospital, MA, N. Mouine - IBN SINA Hospital, MA
- 5. The impact of elevated haemoglobin A1C (HbA1c) and related co-morbidities on morbidity and mortality of patients undergoing coronary artery bypass grafting**
Kumar Rahul - unmicrc, IN

6. Metabolism and acetylation contribute to leucine-mediated inhibition of cardiac glucose uptake

Edith Renguet - Université catholique de Louvain, BE

7. High-intensity interval training is as potent as moderate intensity training in improving cardiac function in healthy rat hearts

Maxim Verboven - U Hasselt, BE

HEART FAILURE

1. Role of BNP dosage in patients over 80 years old admitted for dyspnea in the emergency care unit

Kamilia Chahi - Groupe Jolimont, BE

2. New Onset Congestive Heart Failure After an Acute Coronary Syndrome: Evidence for Shifting Phenotype

Christophe de Meester - Cliniques Universitaires St.-Luc, BE

3. Combining Natriuretic peptides and intact Fibroblast Growth Factor 23 for risk estimation of heart failure patients

Damien Gruson - Cliniques Universitaires St.-Luc, BE

4. Effectiveness of high intensity interval training and strength training in patients with chronic heart failure

Miek Hornikx - UZLeuven / KULeuven, BE

5. Rehabilitation, a key point in capacity evolution of patients implanted with HeartWare® LVAD... TRUE, but there is more to be said!

Michel Lamotte - CUB Erasme, BE

6. Limited Contractile Reserve Contributes to Poor Peak Exercise Capacity in Iron Deficient Heart Failure

Pieter Martens - Ziekenhuis Oost Limburg, BE

7. The Reverse Remodeling Response to Sacubitril/Valsartan Therapy in Heart Failure with Reduced Ejection Fraction *

Pieter Martens - East Limburg Hospital, BE

8. The impact of baseline characteristics differences in patients treated in clinical practice with sacubitril/valsartan versus PARADIGM-HF *

Pieter Martens - East Limburg Hospital, BE

9. Effects of Intravenous Home Dobutamine in Palliative End-stage Heart Failure on Quality of Life, Heart Failure Hospitalization and Cost-expenditure *

Pieter Martens - East Limburg Hospital, BE

10. Value of routine investigations to predict loop diuretic down-titration success in stable heart failure

Pieter Martens - Ziekenhuis Oost Limburg, BE

11. Prognosis and risk score in patients with heart failure with preserved ejection fraction

Clotilde Roy - Cliniques Universitaires St.-Luc, BE

12. Anemia and its prognostic significance in heart failure with preserved ejection fraction

Clotilde Roy - Cliniques Universitaires St.-Luc, BE

13. Differential expression of circulating microRNA in patients with heart failure with reduced ejection fraction responding or not to exercise training

Isabel Witvrouw - Antwerp University Hospital, BE

IMAGING

1. Head to head comparison of 2D and 3D speckle tracking strain vs 2D cardiac magnetic resonance tagging in a multicenter validation study *

Mihaela Amzulescu - Saint-Luc Hospital Brussels, BE

2. Relation of left atrial size and function to atrial arrhythmia burden in patients with paroxysmal atrial fibrillation: a CLOSE-to-CURE echo imaging sub-study *

Philippe Debonnaire - Sint-Jan Bruges, BE

3. Mitral regurgitation: resetting the severity cut-off again? Insights from the API method *

Victor Kamoen - UGent, BE

4. Magnetic resonance or 3D echocardiography provides superior prognostic information in organic mitral regurgitation: a comparison with 2D integrative approach

Martin Penicka - OLV Ziekenhuis Aalst, BE

5. Assessment of left ventricular reverse remodeling by cardiac MRI in patients undergoing repair surgery for severe aortic or mitral regurgitation: an observational prospective cohort study

Stephanie Seldrum - CHU UCL Namur, site Godinne, BE

6. Relative Contribution Of Afterload And Interstitial Tissue Fibrosis To Pre-operative Longitudinal Function In Patients With Severe Aortic Stenosis *

Alisson Slimani - Saint-Luc Hospital Brussels, BE

7. MRI 4D flow assessment of normal and aneurysmatic thoracic aorta

Kaoru Tanaka - UZ Brussels, BE

8. Specificity of myocardial perfusion SPECT in the daily routine practice of the Jolimont's group

Xavier Theunssens - Hôpital de Jolimont, BE

9. Clinical studies and fundamental research: how does exercise intervention affect cardiac function and structure in type 2 diabetes mellitus in the perspective of diabetic cardiomyopathy?

Lisa Van Ryckeghem - Hasselt University, BE, Maxim Verboven - Hasselt University, BE

INVASIVE/INTERVENTIONAL CARDIOLOGY

1. Dual axis rotational coronary angiography versus conventional coronary angiography: a comparative study

Roberto Arcolia - CHU Ambroise Paré Mons, BE

2. Clinical outcomes of heart-team-guided treatment decisions in high-risk patients with aortic valve stenosis in a health-economic context with limited resources for transcatheter valve therapies

Elise Bakelants - UZ Leuven, BE

3. Six-months follow-up of the COBRA II (COmplex Bifurcation lesions: a RANdomized comparison between the AXXESS device with Absorb BVS and Modified T stenting with Absorb BVS) study

Johan Bennett - University Hospitals Leuven, BE

4. Predictors of left ventricular reverse remodeling after MitraClip implantation in patients with severe mitral valve regurgitation

Hiske Brouwer - UZA, BE, Marc Den Heijer - UZA, BE

5. Prognostic value of the high sensitive cardiac troponin T assay after percutaneous coronary interventions of chronic total occlusions

Daan Cottens - ZOL Genk, BE

6. Relation of advanced left ventricular remodeling to outcome in patients undergoing percutaneous mitral valve repair using MitraClip

Philippe Debonnaire - Sint-Jan Bruges, BE

7. Initial clinical experience with sirolimus-eluting magnesium-based bioresorbable vascular scaffold implantation in patients with ST-elevation myocardial infarction

Quentin de Hemptinne - CHU St-Pierre, BE

8. Clinical outcome of patients undergoing a bioresorbable vascular scaffold implantation: data of a real-world cohort from one center in Belgium

Mathieu Deldicque - Cliniques Universitaires St.-Luc, BE, Joëlle Kefer - Cliniques Universitaires St.-Luc, BE

9. 30 years trends in intra-hospital mortality after acute myocardial infarction in the province Luxembourg. Impact of revascularization therapy. Results from the Monica Bellux registry

Bernhard Gerber - Cliniques Universitaires St Luc / UCL, BE, Michel Jeanjean - UCL, BE

10. Adverse outcomes awaiting non-culprit PCI after STEMI. Insights from the STEMI patients with multi-vessel disease Assigned to staged PCI: Gauging adverse Events (STAGE) study

Keir McCutcheon - UZ Leuven- Vlaams, BE

11. Long term follow up of polymeric Bioresorbable Vascular Scaffolds in complex coronary bifurcation interventions

Keir McCutcheon - UZ Leuven- Vlaams, BE, Martin Vanhaverbeke - UZ Leuven- Vlaams, BE

12. Management of left main coronary artery disease. A real-life experience of a single centre

Mohamed Aymen Meddeb - Sahloul Hospital University Center /Faculty of medicine of Sousse, TN, Mehdi Slim - Sahloul University Hospital, TN

13. LM Coronary Artery Stenosis: Ten-Year Outcome After Fractional Flow Reserve-Guided Treatment Strategy

Anastasios Milkas - OLV Ziekenhuis Aalst, BE

14. Proximal Left Anterior Descending Coronary Artery Stenosis: Ten-Year Outcome After Fractional Flow Reserve-Guided Strategy

Anastasios Milkas - OLV Ziekenhuis Aalst, BE

15. The specificity of myocardial perfusion scintigraphy in the daily routine practice.

Jean-Christophe Reiters - Hôpital de Jolimont, BE

16. Long-term outcome after covered stent implantation as a treatment for coronary perforation during PCI

Liesbeth Rosseel - ZNA Middelheim, BE, Paul Vermeersch - ZNA Middelheim, BE

17. Acute cardiac injury and residual high-sensitivity C-reactive protein in patients with myocardial infarction

Maarten Vanhaverbeke - KU Leuven, BE

18. PFO closure in divers and patients with young stroke: evaluation of risks and outcome

Eline Vermeiren - Antwerp University Hospital, BE, Myron de Baar - Antwerp University Hospital, BE, Stephanie De Deckere - Antwerp University Hospital, BE

19. Transcatheter aortic valve implantation for failed small surgical bioprosthesis: single network outcome

Yannick Willemen - Algemeen Stedelijk Ziekenhuis, BE, Ian Buysschaert - Algemeen Stedelijk Ziekenhuis, BE

OTHER

1. Physical activity telecoaching for adults with congenital heart disease.

Preliminary results from the Start2Sport study

Roselien Buys - KU Leuven, BE

2. Atrio Oesophageal Fistula after Radiofrequency Ablation: a Difficult and Rare Diagnostic

Emilie Evrard - GHDC Charleroi site Notre-Dame et Reine Fabiola, BE,

Dan Gusu - GHDC Charleroi site Notre-Dame et Reine Fabiola, BE

3. Cardiopulmonary exercise performance in critical aortic valve stenosis: early impact of minimally invasive aortic valve replacement

Dominique Hansen - Jessa hospital / Hasselt university, BE

4. Do clinicians prescribe exercise according to clinical guidelines in patients with cardiovascular disease? Findings from the European Association of Preventive Cardiology EXPERT (EXercise Prescription in Everyday practice & Rehabilitative Training) working group survey

Dominique Hansen - Jessa hospital / Hasselt university, BE

5. Acute physiological impact of electrical support during cycling in patients with systolic heart failure

Dominique Hansen - Jessa hospital / Hasselt university, BE

6. Impact of exercise training modalities on changes in quality of life during cardiac rehabilitation

Dominique Hansen - Jessa hospital / Hasselt university, BE, Gitte Hooyberghs

- Hasselt university, BE, Amélie Smolders - Hasselt university, BE, Frank

Vandereyt - Jessa hospital, BE

7. Aberrant cardiopulmonary function during exercise testing and exercise intolerance in relation to cardiometabolic health in obese adolescents

Dominique Hansen - Jessa hospital / Hasselt university, BE

8. An impaired cardiac diastolic function and adverse cardiac remodelling independently relates to hyperinsulinemia and insulin resistance in obese adolescents, but not to cardiopulmonary exercise capacity

Dominique Hansen - Jessa hospital / Hasselt university, BE

9. Lean tissue mass loss after coronary artery bypass graft surgery: relation to post-operative clinical status and impact of endurance exercise-based rehabilitation

Dominique Hansen - Jessa hospital / Hasselt university, BE, Hajar Boujemaa - Hasselt university, BE

10. Cardiac imaging at rest is insufficient to understand functional limitations of patients with a systemic right ventricle

Frederik Helsen - UZ Leuven- Vlaams, BE

11. Association between Hemoglobin A1c level and Cardiometabolic Risk Factors in Diabetic Patients

Ahmed Hussein - Sohag University Hospital, EG, Adel Elsayed - Sohag

University Hospital, EG

12. Quality of life, anxiety and depression in patients after cardiac rehabilitation

N. Mouine - Léopold Bellan Hospital, MA, G. Amah - Léopold Bellan Hospital, MA

13. Myocardial disease and arrhythmia in marfan syndrome *

Laura Muiño Mosquera, University Hospital Ghent, BE

14. Abnormal response to exercise in systemic sclerosis patients with normal pulmonary pressures at rest: a case-controlled study

Asma Rimouche - Erasme, BE

15. Natural history of the enlarged ascending thoracic aorta: an observational long term study

Erwin Schröder - CHU UCL Namur - site Godinne, BE

16. One year of PCSK9 inhibition with evolocumab in real world daily practice: promise fulfilled

Yannick Willemen - Algemeen Stedelijk Ziekenhuis, BE, Ian Buysschaert -

Algemeen Stedelijk Ziekenhuis, BE

THE DIGITAL POSTERS ARE SUPPORTED BY MSD



EXHIBITORS

Participants are cordially invited to visit the following stands in the exhibition foyers: Silver (S) - Magritte (M) - Delvaux (D)

Abbott	S1
Actelion	D17
Amgen	M6
Arseus	S14bis
AstraZeneca	D8
Bayer	M4
Biotronik	S13
BMS-Pfizer	M10
Boehringer Ingelheim	M5
BSC/ESC	S
Cardiome	9Ter
Corilus Healthconnect	D24
Daiichi Sankyo Belgium	M11
Edwards Lifesciences	S15bis
Fonds voor Hartchirurgie	S
GE Healthcare	M9 bis
Hospidex (Welch Allyn)	S15
Journal de la Cardiologie	S
Livanova	D23
Medtronic	S2
MSD	M12
Mylan	D16
Novartis Pharma	D20-21
Philips	S3
Roche	D25
Sanofi	M9
Servier	M7
Shire	D22
Therabel Pharma	D18
Tomtec	S4
Vifor Pharma België	D19

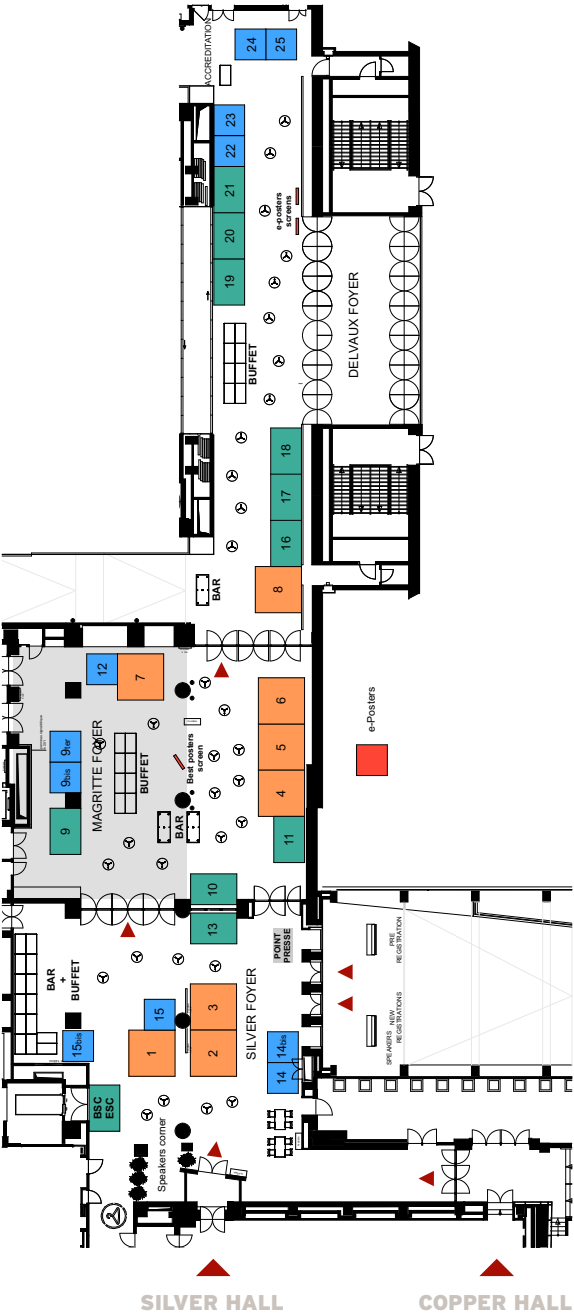

PRACTICAL INFORMATION

VENUE

SQUARE-BRUSSELS MEETING CENTRE
Glass Entrance, Parc du Mont des Arts
B-1000 Brussels
Tel. : +32 2 515 13 00

Wifi: square-guest
Login: bsc
Password: bsc18!

ACCESS

- By tube** SQUARE is accessible using the tube lines 1 & 5, stop Central Station
- By rail** Bruxelles-Central / Brussel-Central, exit signs to 'Mont des Arts - SQUARE'
- By bus** Square is accessible using the bus lines 29 - 38 - 63 - 65 - 66 - 71 - 86, stop Central Station
- By tram** Square is accessible using the tram lines 92 - 93, stop Place Royale
- By air** Brussels International Airport (Zaventem). You can reach the venue by rail (get off at the Brussels Central station) or by taxi
- By road** There is a large parking right underneath Square named Parking Albertine / Albertina. To access the BSC congress, please park at level -3 and take the SQUARE lifts up to level 0 (halls & exhibition level). You can get in via Place de la Justice - Gerechtsplein, 16 at 1000 Brussels, and then walk straight into the building.

WELCOME & REGISTRATION

Badges can be collected at the registration desk (level 0) from 8:00 each morning. You have to wear your badge at all times whilst on the SQUARE premises.

"MEET THE EXPERTS" - SPEAKER CORNER

Meet and chat with foreign experts just after their session in the speaker corner located in the Silver Foyer during each coffee break and at lunchtime

ACCREDITATION

To receive their credits, delegates are invited at the designated accreditation desk located in Delvaux Foyer. Opening hours: 13:15 to 18:00 on 8th and 9th February 2018.

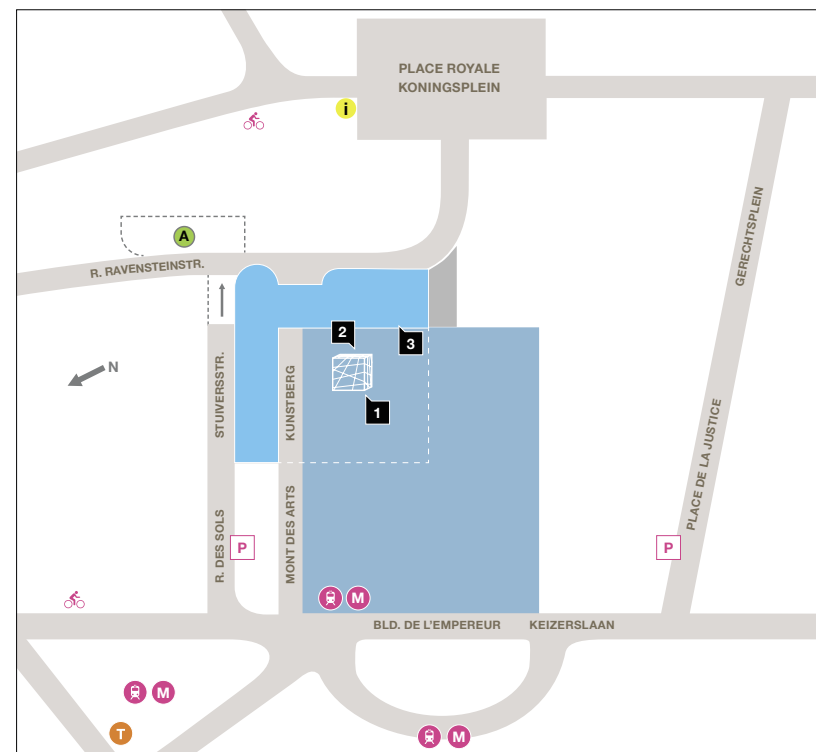

- | | |
|---|----------------------------------|
| 1 Glass entrance (Mont des Arts) | Entrance Central Station |
| 2 Terrace entrance (Mont des Arts) | Entrance Metro Central Station |
| 3 Delvaux entrance Loading & Unloading (Foyers) (Mont des Arts) | Taxi |
| Public parking "Albertine"(direct access to square) (3 rue des Sols or Place de la Justice) | City Bikes disposal |
| | Bozar (direct acces from square) |

NEXT BSC CONGRESS

Save the date!
7th and 8th February 2019
Square, Brussels

ORGANISING SECRETARIAT



Downtown Europe

Professional Congress Organisers

Tel +32 (0)2 732 35 20

Email: bsc@downtowneurope.be

INFO & REGISTRATION

www.bscardio.be

MAJOR SPONSORS

