

# PARTNERS

IN EMERGENCY  
PREPAREDNESS  
CONFERENCE *2014*



**APRIL 22 - 24**

THE GREATER TACOMA  
CONVENTION & TRADE CENTER  
TACOMA, WA

**WWW.PIEPC.ORG**

# 2014 Conference Committee

## PIEPC Executive Committee

**Gail Harris, Conference Chair**  
City of Shoreline

**Kelly Kasper, Vice Chair**  
American Red Cross

**Sarah Miller, Treasurer**  
City of Auburn

**Aaron Collins, Sponsorship Director**  
Starbucks

**Mindi Mattson, Education Director**  
City of Renton

**Lynn Murphy, Marketing Director**  
Puget Sound Energy

**Rick North, Past Chair**  
Nordstrom

**Karen Inglin, Secretary**  
Recreation Equipment, Inc.

## PIEPC Steering Committee

**Darren Brnum**  
University of Washington

**Ted Buehner**  
National Weather Service

**Dana Colwell**  
Washington State University  
Conference Management

**Lit Dudley**  
Washington State Emergency Management

**Cindy Gleason**  
Washington State Department of Health

**Emily Houg**  
Washington State University  
Conference Management

**Barb Jensen**  
EvergreenHealth

**Fritz King**  
Premera Blue Cross

**Brian Knox**  
Premera Blue Cross

**John Labadie**  
Emergency Management Consultant

**Julie Marpert**  
Premera Blue Cross

**Bruce McBane**  
FEMA Reservists

**Shawn McCallister**  
The Boeing Company

**Gretchen O'Connor**  
Washington Association of Community &  
Migrant Health Centers

**Beverly O'Dea**  
Bridgeview Consulting, LLC

**Ed Reed**  
King County Zone 3 Emergency Management

**James Rollins**  
Takouba Security, LLC

**Alicia Schroder-Weitzel**  
U.S. Food & Drug Administration

**Sue Warner-Bean**  
Emergency Response Planning

**Jenny Williams-Bjork**  
DaVita HealthCare Partners

**Rosemary Zorko**  
CBRE/Healthcare: Group Health & MultiCare

# Letter from the Chair



On behalf of the entire Conference Steering Committee, I welcome you all to the **2014 Partners In Emergency Preparedness Conference**. Your Conference Steering Committee has worked hard all year to bring you an outstanding line up of professional workshops, inspiring speakers, and meaningful presentation sessions that will touch all of us. While we all have unique and diverse backgrounds, we all come here committed to developing the needed public/private partnerships that can enable us to face whatever disaster that may challenge us. I am looking forward to the exchange of knowledge and energy that always seems to occur at this conference year after year. In addition, in the true sense of forming partnerships with all of you, we are hopeful you will look around, meet new people, form new alliances, and help us meet our mission of breaking down formal barriers and working together for a common good. There are two formal networking events and several informal time periods where we invite you to meet each other and meet with our exhibitors who support us in our preparedness, response, mitigation, recovery, and continuity missions.

I want to officially thank our sponsors—*Seattle Public Utilities, Puget Sound Energy, Verizon, Witt O'Brien's, Takouba, Premera Blue Cross, Verizon, Washington State Association of Emergency Management, Northeastern University, and Washington State Department of Military Emergency Management Division*—all of which allow us to provide this quality conference this year.

I want to thank all of the instructors, all of whom share their knowledge with us for very little, or no compensation. I want to thank the volunteers who are working the three days of the conference to support the logistics of the conference. I want to thank the terrific all-volunteer conference committee members made up of public, private, and NGOs who have worked all year to provide this excellent conference! I especially want to thank our Event Coordinators from Washington State University Conference Management—Dana Colwell and Emily Houg—for all they do to manage the many details of running this conference! And last, but certainly not least, I want to thank all of you for taking the time out of your busy schedules to spend some time learning from each other!

Sincerely,

*Gail C. Harris*  
2014 PIEPC Conference Chair

# GETTING STARTED at PIEPC

## Registration Desk & Name Tags

The Registration Desk is the place to go if you have any questions during the conference. Please come by and see us during any of the hours listed below. Once you have registered and received your nametag please wear it throughout the conference. Not only will other people get to know your name, it is your meal ticket for all events.

## Exhibit Hall & Opening Reception

Partners in Emergency Preparedness exhibitors and sponsors invite you to visit their booths located next to the registration desk and down the ballroom hallway. The exhibitor networking reception will be held on Wednesday, April 23 from 4:30–7:00 PM. Come see the latest that your emergency preparedness partners have to offer.

Check your conference bag for an exhibitor passport! Get 24 initials on your passport to qualify you for the overnight stay at the Courtyard by Marriott in Tacoma.

There is also a ticket in your registration materials to enter for the door prize drawings, donated from our exhibitors and sponsors for the networking reception.

Tuesday, April 22

12:00 PM–6:00 PM

Wednesday, April 23

7:00 AM–6:00 PM

Thursday, April 24

7:00 AM–3:00 PM

## Emergency Procedure

In the event of an emergency, attendees should stay in place and wait for instructions. The Greater Tacoma Convention & Trade Center Event Manager on duty will locate the Washington State University Event Planners with further instruction. If an evacuation is called, guests will be directed to the nearest exit and evacuation location. Guests will wait with a facility employee until the “all clear” is given to re-enter the building.

If the emergency is clearly medical and assistance is required, **911** should be called immediately. If **911** is called, please notify the WSU Event Planners immediately, who will work with GTCTC staff to ensure proper communication of the emergency with Emergency Responders.

## QR Codes

Presenters who have submitted materials in advance will have QR codes posted outside of their room. If you have a QR code reader app installed on your smart device, you can scan the code to download a copy of the presentation documents.



## Mobile App



We've also created a mobile app to help you navigate the conference this year. Install it to your **iOS** or **Android** device to view the conference schedule, and get information on exhibitors, sponsors, speakers, and more.

<http://ddut.ch/piepc>



# SCHEDULE *At-a-Glance*

**TUESDAY**  
**April 22**

11:00 AM Registration  
*Greater Tacoma Convention & Trade Center*

1:00 PM **Special Workshops (GTCTC)**

**Rm. 317** Essentials of Cybersecurity (AWR 136) (Natalie Granado)

**Rm. 318** Rapid Needs Assessment (G 557) (James Yates)

**Rm. 315** Rapid Visual Screening (RVS) of Buildings for Potential Seismic Hazards (ATC-21 & FEMA 154)  
(David Swanson)

**Rm. 316** Get Your Message Across: Communicating Emergency Preparedness Messages (Michael Buschmohle)

2:45 PM Exhibitor Break

3:00 PM Special Workshops continue

5:00 PM Networking Reception (Open to all registered conference attendees.)  
*Hotel Murano Ballroom*

**WEDNESDAY**  
**April 23**

7:00 AM Breakfast, Registration & Exhibitor Display

8:00 AM **Welcome**  
Gail Harris, PIEPC Chair

8:10 AM **“State of the State” Emergency Management**  
Robert Ezelle, Director of State Emergency Management

8:20 AM **KEYNOTE Full Rip 9.0**  
Sandi Doughton, Author & Seattle Times Science Reporter

9:00 AM Exhibitor Break

9:30 AM **Session A**

**Rm. 405** Lessons Learned for Nevado del Ruiz: A Panel Discussion of the Washington State Visit to Nevado del Ruiz, Colombia (Panel led by John Ewert, Scientist-in-Charge)

**Rm. 315** Developing a Measurable Business Continuity Program: Metrics & Maturity (Ron Kamps)

**Rm. 317** Standing on the Riverbank: Lessons from the Skagit Bridge Collapse (Marcus Deyerin)

**Rm. 318** You Asked, They Came; Now What? Building & Maintaining a Positive Volunteer Program  
(Dave Nichols)

**Rm. 316** The Updated Cascadia Subduction Zone Scenario (Joan Gomberg/Tamra Biascol/Heidi Kandathil)

**Rm. 404** Can ICS Really Work for Law Enforcement Ops? (Martin F. Grisham)

**Rm. 407** Bringing It Home: Lessons Learned from a Year in Federal Public Service (Frank Sanborn)

10:45 AM Exhibitor Break

11:00 AM **Session B**

**Rm. 317** Rivers in the Sky Are Flooding the Northwest (Lawrence Schick)

# SCHEDULE *At-a-Glance*

**WEDNESDAY April 23 (cont'd)**

**Rm. 407** **Building Partnerships through 2013 Public Health Full Scale Exercise** (Sally Abbott/David Owens/Shawn Roberts/Lianne Martinez/Brad Halstead)

**Rm. 315** **Washington Coalition of Recovery Planners: Building Partnerships through Recovery Planning** (Jason Biermann/Casey Broom)

**Rm. 318** **Digital Detectives & Virtual Volunteers: The Impact of Emergent Social Media Platforms on Homeland Security** (Alisha Griswold/Pascal Schuback)

**Rm. 405** **Child Abduction Response Teams...Why Emergency Management Should Be Involved** (Amy Gillespie/Lt. Rob Jepson/Detective Lindsey Wade)

**Rm. 404** **Seafair Emergency Management Group: Behind the Scenes** (Darren Branum)

**Rm. 316** **User Guides for Regional Catastrophic Preparedness** (Robert Ezelle/Fauna Larkin/Sandy Johnson/Natasha Fedo)

12:30 PM **LUNCH PANEL DISCUSSION SR-530 Slide: Initial Lessons Learned**

## 1:30 PM **Session C**

**Rm. 407** **[ISO 22301] Business Continuity Management Systems: Overview for Planners** (Jan Decker)

**Rm. 316** **The Evolution of Social Media During Disasters: From the Joplin Tornado to Hurricane Sandy and Beyond** (Suzanne Bernier)

**Rm. 318** **No Budget EOC Tools: University of Washington Keeps it Innovative, Simple & Accessible** (Siri McLean/Andy Ward/Pascal Schuback)

**Rm. 315** **Disturbing Lessons from the Severe Flooding in Queensland, Australia January 2011** (Lawrence Schick)

**Rm. 405** **Disaster Planning for the Management of Cultural Resources and Assets** (Allyson Brooks/Mark Eberlein)

**Rm. 404** **Landslides & Emergency Response: Fundamentals & a Recent Case History\*** (J. Gordon/Michael Warfel) *\*To include critical information about response to the SR-530 Slide.*

**Rm. 317** **Crisis Management: How to Manage a Mass Fatality Incident** (Frank Ciaccio)

2:45 PM Exhibitor Break

## 3:15 PM **Session D**

**Rm. 405** **Taking the Mystery Out of Working with the Disability Community** (Deborah Witmer/Laura Gramer/Jonathan Porter)

**Rm. 315** **Tools to Support Decision-Makers During Regional Health & Medical Catastrophes** (Michael Loehr/Ashley Kelmore)

**Rm. 404** **Importance of Internships: Integrating Internships into Your Organization...It's Good for Business** (Linda Crerar/Robert Lord)

**Rm. 318** **Readiness Is a Predictive Measure** (James Rollins)

**Rm. 407** **Using Hazus for Preparedness & Emergency Response** (Kelly Stone)

**Rm. 316** **Superstorm Sandy: New Jersey's Largest 911 Call (The Story of One of the Most Historical EMS Responses in the Nation)** (Henry Cortacans)

**Rm. 317** **Mitigating a School Crisis: An All Hazards Approach** (Jason Esper)

4:30 PM Exhibitor Networking Reception

# SCHEDULE **At-a-Glance**

**THURSDAY April 24**

7:00 AM Breakfast, Registration & Exhibitor Display

8:00 AM Welcome

8:10 AM **PLENARY SESSION** **Create Your Own Flight Plan**  
David Sanderson, "The Miracle on the Hudson Survivor"

9:00 AM Exhibitor Break

## 9:30 AM **Session E**

**Rm. 405** **What You Need to Know about Cybersecurity** (Alisha Griswold)

**Rm. 317** **COOP: From Start to Finish & Back Again** (Patti Richards)

**Rm. 316** **Partners in Weather Preparedness: New Technologies You Need to Know** (Ted Beuhner)

**Rm. 318** **After the Lessons are Learned: Effective Improvement Plan Management** (Ashley Kelmore)

**Rm. 407** **Building Partnerships between Public Works & Emergency Management** (Amy Gillespie/  
Kirk Holmes)

**Rm. 315** **Beyond the Buzzword: How to Effectively Collaborate During Disaster Response** (Lacey Croco)

**Rm. 404** **Practicalities of EM in Incidents & Special Events** (Scott Preston)

10:45 AM Exhibitor Break

## 11:00 AM **Session F**

**Rm. 318** **Culturally Responsive Emergency Management** (Sharon Knight)

**Rm. 404** **Continuity of Governance: Emergency Response Planning for City Legislative Departments**  
(Phyllis Shulman/Christie Villa)

**Rm. 315** **ShelterBox Philippines Deployment: Two Deployments in One** (Dave Nichols)

**Rm. 405** **Is Your "Whole Community" Ready?** (Frank Castro-Wehr/Ramona Armijo)

**Rm. 316** **The I-5 Skagit River Bridge Collapse: A Lesson in Multi-Agency Coordination** (Mark  
Watkinson/Bill Vlcek/William Lokey)

**Rm. 407** **The Receiving End of the Notification: A Change in Perspective from Emergency Manager  
to Evacuee** (Lacey Croco)

**Rm. 317** **Local Emergency Management Program Assessment Tool & WAC 118-30 Updates** (Diane  
Newman/John Ufford)

12:15 PM Lunch

1:00 PM **PLENARY SESSION** **From Surviving to Thriving: How We Learn to Be Resilient**  
Adrienne Haslet-Davis, Boston Marathon Bombing Survivor

## Special Workshops: 1:00 PM – 5:00 PM

---

### **W1: Essentials of Cybersecurity (AWR 136) ..... Room 317**

*Presented by: Natalie Granado, TEEEX*

The course provides individuals, community leaders and first-responders with information on how cyber-attacks can impact, prevent, and/or stop operations and emergency responses in a community. It also serves as a cursory introduction to cyber threats, vulnerabilities and countermeasures. It explains vulnerabilities of computer systems and networks and how these vulnerabilities can affect communities. The course introduces actions communities can take in establishing a cybersecurity program.

### **W2: Rapid Assessment Workshop (G557) ..... Room 318**

*Presented by: James Yates, Emergency Management Division*

The ability to perform a rapid needs assessment accurately and within the first few hours after an incident is critical to providing response for life threatening and imminent hazards. Coordinated and timely assessments permit local government to prioritize response activities, allocate scarce resources and request mutual aid and State & Federal assistance. Workshop activities, facilitated exercises and instructor lead group discussion are utilized in this course to provide participants with the skills to perform assessment.

### **W3: Rapid Visual Screening (RVS) of Buildings for Potential Seismic Hazards (ATC-21 & FEMA 154) ..... Room 315**

*Presented by: David Swanson, Reid Middleton, Inc*

The startling frequency of large devastating earthquakes that have occurred around the world are a potent reminder about the importance of disaster preparedness of our communities. After such large-scale disasters, building owners, facility managers, portfolio managers, contingency planners and emergency managers often want to know what the earthquake risk is to their facilities. Owners of large and diverse portfolios of buildings need a way to quickly and methodically screen their facility portfolio for potential seismic hazards. This work can lead to implementation of holistic facility-wide seismic safety and risk reduction programs.

Rapid Visual Screening of Buildings for Potential Seismic Hazards (ATC-21 and FEMA 154) is a methodology on how to identify potentially hazardous buildings before earthquakes occur. The methodology enables personnel to rapidly identify, inventory, and rank buildings according to their expected safety and usability during and after earthquakes. This information can be used to plan and prioritize further engineering and vulnerability analysis and to identify emergency-response needs and mitigation opportunities.

The 2014 Partners in Preparedness Conference is providing a four hour pre-conference training session on Rapid Visual Screening for Potential Seismic Hazards (ATC-21/FEMA 154) to help you develop the necessary skills to properly screen existing buildings for seismic hazards. Taught by Structural Engineers with hands-on experience, you will learn the rapid visual screening methods and how to use the checklists and tools necessary to





perform this work. Building seismic performance from real-life examples of earthquake, tsunami, and wind damaged buildings from significant disasters in the United States, Taiwan, China, Haiti, Chile, New Zealand and Japan will be utilized to demonstrate the rapid visual screening concepts and approach.

Training topics include:

- A detailed presentation of ATC-21/FEMA 154 Rapid Visual Screening procedures.
- Examples of building performance and seismic hazards from significant earthquakes in California, Washington, Chile, Haiti, China, Japan, Taiwan, and New Zealand.
- How do buildings structurally react to earthquake forces and other extreme loading?
- Procedures and example exercises for buildings constructed from wood, masonry, concrete, and steel.
- Project scenarios and examples of Rapid Visual Screening programs for building owners with large property portfolios.

#### **W4: Get Your Message Across: Communicating Emergency Preparedness Messages ..... Room 316**

*Presented by: Michael Buschmohle, Applause Associates*

**Messages.** What are the elements of messages that resonate with people and encourage them to listen, believe, and respond? Tips on the psychology of persuasion, word choices, and sentence structures...for speaking and writing.

**Structure.** How can you organize a presentation to persuade? How to open any presentation in 30 seconds or less and have listeners eager to listen. Tips on writing speeches, using PowerPoint, telling stories, and delivering statistics.

**Delivery.** How can a speaker look and sound convincing? Tips on looking professional, using your voice as well as broadcasters, managing body language, overcoming nervousness, and ending on time.

**Challenges.** How can you handle conflict and disagreement? Tips on answering questions (even when you don't know the answer), handling audience resistance and disagreements with composure, and encouraging follow up.

KEYNOTE 8:00 AM

## Sandi Doughton Full Rip 9.0

Science Writer *Seattle Times*

**Ballroom**



Sandi Doughton is an award-winning science writer for *The Seattle Times* and the author of *Full Rip 9.0: The Next Big Earthquake* in the Pacific Northwest. Doughton has been covering Northwest earthquakes for nearly 20 years, first at *The News Tribune* of Tacoma and for the past decade at *The Seattle Times*.

Doughton set out to be a biologist, but after graduate research that required her to stand in a walk-in freezer and drip rattlesnake venom into test tubes, she decided to combine her interests in journalism and science.

Her first science-writing job was in Los Alamos, New Mexico, birthplace of the atomic bomb and the center of some of the country's most cutting edge and controversial research—including work on laser fusion and the “Star Wars” missile defense system.

Her science reporting has taken her to the Bering Sea, where she covered climate change and chased seals over pancake ice, and to Africa, where she wrote about the Gates Foundation's efforts to develop a vaccine for malaria. But earthquake science is her favorite subject, because it's a great example of the way research can make a difference in people's lives.

## Session A: 9:30 AM – 10:45 AM

### A1: **Lessons Learned for Nevado del Ruiz: A Panel Discussion of the Washington State Visit to Nevado del Ruiz, Colombia** ..... **Room 405**

*Presented by:* John Ewert, Andrew B. Lockhart & Carolyn L. Driedger, USGS-Cascades Volcano Observatory; John Schelling, Washington State Military Department's Emergency Management Division; Zane Gibson, Orting Valley Fire and Rescue; Frances Burkhart, Whatcom County Sheriff's Office Division of Emergency Management; Dan Banks, Office of Emergency Preparedness and Response, Washington State Department of Health; Kyle Bustad, Pierce County Department of Emergency Management; Scott R. Beason, Mount Rainier National Park; Rob Allen, Pierce County Economic Development Department

On November 13, 1985, the Nevado del Ruiz Volcano in Columbia erupted violently generating a lahar that swept down the valleys draining the summit area causing more than 23,000 casualties. As an opportunity to learn from this incident and subsequent planning, a group of ten people from Washington State representing Federal, State, and Local emergency managers, planners and scientist visited Columbia as part of a bi-national exchange with their Columbian Counterparts that have similar responsibilities. Subsequently, the Columbians visited Washington State to learn from our efforts at volcano preparedness and mitigation.



This visit provided an opportunity for the participants to see what the effects of the 1985 eruption had on the community and critical infrastructure, and the planning and mitigation activities that followed that incident. This panel discussion will be an opportunity for the audience to take away some of the lessons learned from Columbia and make the connections to further their preparedness planning and mitigation efforts with respect to volcanoes in the Pacific Northwest that pose a similar threat.

**A2: Developing a Measurable Business Continuity Program: Metrics & Maturity** ..... **Room 315**

*Presented by: Ron Kamps, Federal Home Loan Bank Seattle*

This session will walk the audience through an approach to developing a business continuity program that is measurable and has room for growth through maturity. Ron will share insights from working in four different industries and how building plans based on data allows for metrics and reporting which provide clear data points that allow executives to make good decisions and prioritize activities.

**A3: Standing on the Riverbank: Lessons from the Skagit Bridge Collapse PIO** ..... **Room 317**

*Presented by: Marcus Deyerin, Whatcom County Health Department*

This presentation will share the perspective and experience of the initial on-scene public information officer for the I-5 Skagit Bridge Collapse incident. Particular emphasis will be given toward the “if I could do it over again—what would I do better next time” perspective, with specific recommendations for other PIOs that may find themselves in a similar situation one day.

**A4: You Asked, They Came; Now What? Building & Maintaining a Positive Volunteer Program**..... **Room 318**

*Presented by: Dave Nichols, CEM, Public Health Seattle & King County*

Disaster Volunteers are not the same type of volunteer as a museum docent. Disaster volunteers are willing to show up when the chips are down. As we move through budget cuts and doing more with less, it is imperative that we not waste this valuable resource. This presentation will focus on not only how to find those special people; but we will also talk about how to keep them engaged and ready. It takes work to make that happen. I will focus on my volunteer program and other programs that have shown they are running excellent programs.

**A5: Updated Cascadia Subduction Zone Scenario**..... **Room 316**

*Presented by: Heidi Kandathil, Cascadia Region Earthquake Workgroup*

As recent events in Chile and Japan attest, great subduction zone earthquakes shape our environment in many ways. Such events and advances in our understanding led the Cascadia Regional Earthquake Workgroup (CREW) to update the report “Cascadia Subduction Zone Earthquakes: A Magnitude 9.0 Earthquake Scenario”. In everyday language and visually, the Scenario provides a tangible picture of the reasons for and consequences of a great Cascadia earthquake, and guidance about how to prepare for and continue to prosper when the event occurs. We present highlights from the Scenario, beginning with a

# WEDNESDAY April 23

brief scientific overview of how and why great subduction zone earthquakes occur, with a tsunami generation sidebar. We review the likely impacts of a great Cascadia earthquake on the Northwest and even globally, focusing on critical infrastructure and buildings and how coastal communities and displaced persons will be affected. Of course, preparations will reduce impacts and speed recovery. We summarize some of the latest assessments and actions taken locally and regionally to make the Northwest more resilient; e.g., those that raise public awareness, new engineering practices, and early warning systems.

## **A6: Can ICS Really Work for Law Enforcement Ops?..... Room 404**

*Presented by: Martin F. Grisham, City of Tukwila*

The City of Tukwila had one of the largest police events, involving over 16 different agencies, 500 players and just about every level of law enforcement agencies from local to Federal. See how ICS was used to support this operation in the coordination, planning and logistical aspects of the event.

## **A7: Bringing It Home: Lessons Learned from a Year in Federal Public Service (FEMA & HHS) ..... Room 407**

*Presented by: Frank Sanborn, Global Disaster Innovation Group*

Hear about how NYC local communities organizations worked to support their whole community. Then work through how we can work together to ensure our local communities have the resources they need to support their citizens.

---

## **Session B: 11:00 AM – 12:15 PM**

## **B1: Rivers in the Sky Are Flooding the Northwest..... Room 317**

*Presented by: Lawrence Schick, US Army Corps (Seattle District)*

Like a giant outstretched fist, thousands of miles long but only as wide as the distance between Seattle and Portland, a “river” of moisture streaks from near Hawaii toward the Pacific Northwest. This river in the sky carries more than ten times the water of the Columbia. It’s called an “atmospheric river” and you better pay attention because it produces extreme rainfall, deadly landslides and major flooding. When heavy rainfall runoff is concentrated by the steep Cascade Mountains, major floods are produced in western Washington. Those storms present huge flood risk management challenges. The U.S. Army Corps of Engineers, in Seattle provides flood risk reduction by operating dams and coordinating emergency management. Many difficult judgments and choices arise when practicing flood risk management. We’ll explore the top NW flooding myths while you’ll discover the singular cause of all major floods in western Washington. Several major floods, in the past ten years, will be used as examples of how flood risk is managed with different and changing conditions. Understand how flood risk management tools are used and critical decisions are made, while we weave through a review of recent, historic floods in Western Washington.



**B2: Building Partnerships through 2013 Public Health Full Scale Exercise.... Room 407**

*Presented by: Sally Abbott, Brad Halstead, David Owens & Shawn Roberts, Washington State Department of Health; Lianne Martinez, Clark County Public Health Department*

Clark County Public Health Department and WA Department of Health led the Public Health 2013 Full Scale Exercise that focused on identification and response to anthrax. Partner agencies included Region 4 emergency management, hospitals, amateur radio operators, mental health, Medical Reserve Corps, and health departments, as well as Washington Departments of Emergency Management, Enterprise Services, Social and Health Services, Transportation and State Patrol. This three day exercise included the following activities: epidemiology, communication, state request for the Strategic National Stockpile, local requests for antibiotics, and the dispensing of appropriate medication, including healthcare workers (CDC Capabilities 3: Emergency Operations Coordination; 4: Emergency Public Information and Warning; 8: Medical Countermeasure Dispensing; 10: Medical Surge; 13 Public Health Surveillance and Epidemiological Investigation and FEMA Core Capability: Operational Coordination). During this session, we will describe the exercise, including coordination, challenges, and successes through the eyes of local and state health departments.

**B3: Washington Coalition of Recovery Planners: Building Partnerships through Recovery Planning..... Room 315**

*Presented by: Jason Biermann, Snohomish County Department of Emergency Management*

Members of the newly formed Washington Coalition of Recovery Planners (WA CORPS) will share lessons learned from their experiences with building partnerships during recovery planning. Specifically, with the emphasis on recovery planning, it is imperative to know who and how to engage the right parties in this planning effort. This presentation will help those who are beginning to undertake this extremely complex endeavor. There will also be an audience participation component to this presentation, as everyone will be asked to think outside the box with whom and how to build partnerships. Panelists represent a variety of jurisdictions and the state that are in various phases of their recovery planning processes.

**B4: Digital Detectives & Virtual Volunteers: The Impact of Emergent Social Media Platforms on Homeland Security ..... Room 318**

*Presented by: Alisha Griswold, Port of Seattle & Pascal Schuback, University of Washington*

This session will go beyond Facebook and Twitter, for a look at up and coming social media platforms and how they have impacted homeland security, and law enforcement investigations. Case studies will include the Dorner Stand-off, Superstorm Sandy, and the Boston Marathon Bombing.

**B5: Child Abduction Response Teams: Why Emergency Management Should Be Involved ..... Room 405**

*Presented by: Amy Gillespie, Pierce County Department of Emergency Management; Lt. Rob Jepson, Tacoma Police Investigations Bureau; Detective Lindsey Wade, Tacoma Police Department*

Law Enforcement agencies across this State are beginning the process of developing certified CART teams. Emergency Management programs are significant role players in the development of these teams. Pierce County Emergency Management will share their

# WEDNESDAY April 23

insight and lessons learned from working with the Pierce County Sheriff's Office and the Tacoma Police Department in achieving certified CART teams and a CART team activation.

## **B6: Seafair Emergency Management Group: Behind the Scenes ..... Room 404**

*Presented by: Darren Branum, Seafair Emergency Management*

What does it take to coordinate emergency management activities for several major city-wide celebrations that include marathons, parades, triathlon, boat race and an air show? The session will take a look at the behind the scenes of the Seafair Emergency Management Group & Emergency Operations Center.

## **B7: User Guides for Regional Catastrophic Preparedness ..... Room 316**

*Presented by: Robert Ezelle, Washington State EMD; Natasha Fedo & Fauna Larkin, BERK Consulting*

Checklists save lives. Emergency managers want to save lives. Seems like a match waiting to happen. Why wait? The Regional Catastrophic Preparedness Grant Program team wants to share with you keys to unlock the mother lode of catastrophic preparedness checklists, tools and templates available to emergency managers in Washington State. Join this session for hands-on learning that will leave you and your agency better informed, organized and motivated to prepare for a catastrophic incident.

**LUNCH PRESENTATION 12:30 PM**

## **SR-530 Slide Initial Lessons Learned**

**John Pennington**

**Ballroom**

The Director of Snohomish County Department of Emergency Management will report on the initial lessons learned about the response and coordination of the SR-530 slide disaster during lunch.





## Session C: 1:30 PM – 2:45 PM

### **C1: ISO 22301: Business Continuity Management Systems Overview for Planners ..... Room 407**

*Presented by: Jan Decker, Crisis Management Consulting*

ISO 22301BCMS is the recognized standard in the US and global marketplace with professionals in companies, universities, large agencies, and can be applied to any organization for a comprehensive and integrated Business Continuity Management System. This presentation will explain what this standard is, how it is used, and why a professional would want to achieve the professional certification of an ISO 22301 Business Continuity Management System (BCMS) Lead Implementer. We will look at examples or models of documentation brought by the presenter and highlight the benefits of an ISO 22301 model for an organization. We will also provide a comparison with the FEMA COOP program and the NFPA 1600 elements.

### **C2: The Evolution of Social Media During Disasters: From the Joplin Tornado to Hurricane Sandy & Beyond ..... Room 316**

*Presented by: Suzanne Bernier, CEM, CBCP, MBCI, SB Crisis Consulting*

The presentation will focus on the evolution of social media use during disasters, focusing on three specific social media success stories—the 2011 Joplin, MO tornado, Hurricane Sandy in 2012 and the Boston bombings in 2013.

The first case study will examine the effective use of Facebook immediately following the Joplin tornado, with the creation of the Joplin Tornado Info (JTI) Facebook page. Having visited Joplin following the tornado and met with the creators of JTI, the presenter will share their insights and lessons learned on social media use during disasters.

The second case study will examine the use of social media before, during and after Hurricane Sandy, which is being heralded as a true social media success story. Throughout the storm, NYC.gov, Facebook, Flickr, Twitter, Tumblr, Instagram and YouTube informed people in near real-time. The presenter will review in detail how social media was used effectively during the preparedness, response and recovery phases of Hurricane Sandy.

The presenter will also discuss how the Boston Police Department successfully used Twitter following the Boston bombings, as well as her observations on the use of social media during the Calgary floods.

### **C3: No Budget EOC Tools: University of Washington Keeps it Innovative, Simple & Accessible ..... Room 318**

*Presented by: Siri McLean, University of Washington Emergency Management; Pascal Schuback; Andy Ward, Information Technology*

In the times of no funding, limited resources and an exploding digital world the UW has created its own Virtual EOC using the Google platform. Learn of their challenges and successes to a better tool for all.

## **C4: Disturbing Lessons from Severe Flooding in Queensland (Jan. 2011)..... Room 315**

*Presented by: Lawrence Schick, US Army Corps (Seattle District)*

Dam engineers are indicted, billions in losses, thirty-seven dead, 1 in 2000 year rainfall, historic flooding. This is the story of a huge flood and major tragedy for the people of Queensland, Australia. The heavy rainfall challenged dam operations and caused severe flooding in and near Brisbane, Australia. Extreme flooding was endured, but a major disaster was barely avoided. This is a classic example of accepting a large flood risk, to avoid a catastrophic flood.

One unsettling part of the story was the continued political storm which followed. Who was to blame? Was it the dam engineers, forecasters, politicians who allowed floodplain development or widespread ignorance of the real flood threat? Or a case of weather gone wild? Five thousand lawsuits worth billions of dollars are pending.

The presenter was part of a small U.S. team of seven dam engineers and scientists from the U.S. Army Corps of Engineers and the Bureau of Reclamation assigned to produce an independent review of the Australian report of this extreme flood.

*Full Australian Flood Report, with links to our review (released Sept 2012): <http://www.derm.qld.gov.au/commission/documents/report-append.pdf>*

## **C5: Disaster Planning for the Management of Cultural Resources & Assets .... Room 405**

*Presented by: Allyson Brooks & Mark Eberlein, Department of Archaeology & Historic Preservation*

Emergency and disaster preparedness for the protection of cultural resources and assets has been lagging when compared to other fields. In Washington State cultural resources and assets include historic structures, archaeological sites, artifacts, libraries, archives, traditional cultural properties etc. Washington State and FEMA together have one of the most advanced cultural data delivery systems in the United States however this is not widely known by emergency management professionals. FEMA and the Department of Archaeology and Historic Preservation will review the laws associated with the consideration of cultural resources during disaster planning, the need to coordinate with tribes, useful tools that are available, and how the agencies responded together during the Nisqually earthquake on identifying impacts to historic and cultural places and then managing the appropriate course of action.

## **C6: Landslides & Emergency Response: Fundamentals & Case History\* ..... Room 404**

*Presented by: J. Gordon & Michael Warfel, GeoEngineers, Inc.*

***\*Session will include critical information about the response to the SR-530 Slide.***

On March 27, 2013, at approximately 3:45 AM, a 1,000-foot-wide section of the bluff along the west coast of Whidbey Island, Washington, slid down the slope into Puget Sound. Officially named the Ledgewood-Bonair (LB) Landslide, it is a small portion of a much larger prehistoric landslide complex that formed as much as 11,000 years ago. The slide mass moved about 250 feet into the water and displaced one residence about 150 feet vertically and 40 feet horizontally. The powerful slide destroyed upwards of 600 feet of Driftwood Way, the local access road near the shoreline. Fortunately there were no injuries, but one house was destroyed, five houses were immediately yellow-tagged and will be red tagged, access to 14 homes was temporarily lost due to road damage. Data and





facts from this case history will support a discussion of how landslides occur, what we can do to proactively identify landslide-prone areas and mitigate potential impacts to life and property, and how scientists and engineers can effectively collaborate with officials and the public in communicating potential landslide risks and responding to landslide events.

## **C7: Crisis Management: How to Manage a Mass Fatality Incident ..... Room 317**

*Presented by: Frank Ciaccio, FC Forensic Consulting*

The processing and management of a Mass Fatality Incident in the United States has drastically changed with the passage of federal legislation involving aviation accidents and the terrorist attacks of September 11, 2001. Whether after a natural incident (e.g., hurricane, earthquake) or accidental incident (e.g., airplane crash, building collapse), the victims must be recovered and positively identified, and care must be shown to the families.

It is crucial that government agencies have mass fatality or emergency response plans in place that provides guidance and a framework with which to handle the crisis. With every incident or mass disaster, lessons are learned and it is important to implement these lessons into plans in order to avoid the same mistakes in the future.

The overall management of Mass Fatality Incidents is extremely complex and taxing on the local, state and federal government agencies' resources. There are multiple challenges that government agencies face when dealing with a mass fatality incident: Issues with communication, data management of identification records, establishing a Family Assistance Center, morgue operations and handling the entire crisis as whole rather than as individual segments.

---

## **Session D: 3:15 PM – 4:30 PM**

---

### **D1: Taking the Mystery Out of Working with the Disability Community ..... Room 405**

*Presented by: Laura Gramer, Jonathan Porter & Deborah Witmer, Seattle Commission for People with disabilities*

The Whole Community approach to Emergency Planning can feel daunting, and working with people with disabilities can perhaps be one of the hardest nuts to crack. This presentation will take the mystery out of that process. The Seattle Commission for People with disabilities' Public Safety Committee has led the effort to educate first responders and emergency management professionals on the capabilities and needs of the disability community as well as how to respectfully interact and engage with individuals with disabilities. They have been successful with educating professionals, compiling resources and developing tools to further the goal of preparing the community from a universal design perspective.

### **D2: Regional Decision-Making Tools: High-Level Overviews for High-Level Decision-Making in a Catastrophe ..... Room 315**

*Presented by: Michael Loehr & Ashley Kelmore, Washington State Department of Health*

During a catastrophe there are many decisions that must be made quickly and with limited information. Scarce resources must be distributed among many organizations with the aim

of providing assistance to the greatest number of people. A visually-based decision support tool can provide decision-makers with a more complete picture of impacts, capabilities and needs without extraneous detail frequently included within situation reports. Through the Regional Catastrophic Grant Program, Public Health – Seattle & King County staff members have prepared an easy-to-use tool that relies on a minimal number of basic, high-level questions to provide an overview of the medical situation in the eight counties of the Puget Sound Area. This allows decision-makers to assess needs and determine where resources may be best used. While this tool is specific to medical resources, the logic behind it can be reproduced for other situations where multiple jurisdictions are competing for limited resources.

### **D3: Importance of Internships: Integrating Internships into Your Organization... It's Good for Business..... Room 404**

*Presented by: Linda Crerar & Robert Lord, Pierce College*

This session is designed to help public, private and non-profits effectively integrate interns into their organizations and maintain strong relationships with their academic community to ensure continuity and long term success. The session will help participants understand the importance of providing students with a “real world” experience that helps them to integrate and apply the academic knowledge they have gained. Participants will understand the importance of a well-managed and well-executed program. They will learn how to design and manage a successful program which utilizes a focused performance based approach linked with academics. Participants will hear from program coordinators and students about the opportunities and challenges for both students and academic programs and lessons learned about how to overcome the challenges to reach the desired outcomes. The session will provide resource information and tools to each participant giving them a road map to implement a successful program and at the conclusion there will be an interactive Q & A.

### **D4: Readiness is a Predictive Measure..... Room 318**

*Presented by: James Rollins, Takouba Security, LLC*

How do we know how our organizations will stand up in a crisis? How will our leaders respond? How do we communicate the relative competence of our organization to others? These questions and more will be answered in this brief introduction to competency based organizational assessment techniques.

How we define quality in terms of the capability we provide and how we measure the organizational response in context to the crisis will influence a measure of performance. The measure of performance can then be correlated with a prediction of performance in an actual crisis.

There are various factors which will influence outcomes in a crisis situation. The amount of time that has passed since the last training event, the degree to which the staff is individually trained, and the rate that people turn over in the organization can all negatively influence the quality of the crisis response. When coupled with availability of qualified leaders, these factors can be measured to predict the quality of the crisis response.

**D5: Using Hazus for Preparedness & Emergency Response ..... Room 407**

*Presented by: Kelly Stone, FEMA Region X*

Hazus is used in conjunction with ArcGIS to estimate losses for flood, hurricane, earthquake, and tsunami (in development) hazards. Hazus can be used during a disaster event or to plan/prepare for a disaster event which will enable communities to respond quickly and pre-position resources. An overview of Hazus including hazard information as well as required inputs for flood and earthquake will be provided. Local results will be highlighted for Pacific, Grays Harbor, Pierce, and Thurston counties for both flood and earthquake hazards including detailed building loss estimates. Identifying buildings at risk from flooding and earthquake hazards can be used for mitigation action projects including acquisitions or elevations of properties, retrofitting buildings, developing targeted outreach, and in future land use decisions. In addition the FEMA GeoPortal Online will be previewed which is used to display various FEMA and State datasets during disasters.

**D6: Superstorm Sandy: New Jersey's Largest 911 Call (The Story of One of the Most Historical EMS Responses in the Nation)..... Room 316**

*Presented by: Henry Cortacans, EMS Task Force, State of New Jersey*

New Jersey's response to Hurricane Sandy was unprecedented in that this disaster affected the entire eastern seaboard with New Jersey as the epicenter. New Jersey's EMS system has prepared for years to respond to large scale events, however, this super storm would prove to challenge New Jersey's EMS response in an unparalleled manner. This session will detail the EMS response to this catastrophe, including the coordinated effort with other state and federal partners, which was instrumental to its overall response that undoubtedly saved lives.

**D7: Mitigating a School Crisis: An All Hazards Approach..... Room 317**

*Presented by: Jason Esper, EM Consultant*

This session is designed to help school officials lessen the effects of an incident that may happen at their school. Instructors will lead the participants through a process of: Hazard Identification and Assessment, Planning, Training, Exercises, and building relationships with first responders in their community. Hazard Identification will be discussed from both man-made and natural events; events with warning and those without. The importance of Emergency Operation Plans (EOPs), Continuity of Operation Plans (COOP), and classroom checklists will be explored. Training will cover both personal preparedness, as well as preparedness from an educator standpoint. Students will be given best practices on building classroom evacuation kits, and shelter-in-place. By familiarizing students with first response systems (ICS/NIMS), they will learn how to integrate the school response into that system. The session will spend time on Joint Information Systems, and necessity to speak with "one voice". During the final phase of a crisis, instructors will cover both short and long term recovery. Focuses will be on student and employee mental health and memorials. The session will conclude with "getting back to normal", and back to the business of education.

## David Sanderson Create Your Own Flight Plan

“The Miracle on the Hudson Survivor”

Ballroom



On January 15, 2009, returning home from a routine business trip, Dave Sanderson survived “The Miracle on the Hudson.” When a bird strike hit US Airways Flight 1549, there was no choice for the crew but to ditch the plane into the Hudson River. Sitting on the plane, in what many would consider to be the wrong place and the wrong time, Sanderson knew he was exactly where he was supposed to be. Thinking only of helping others in the crisis, Dave Sanderson became the last person off of the back of the plane that day, and was largely responsible for making sure so many others made it out safely.

Exposed to frigid water and freezing temperatures, doctors feared that that he would suffer a heart attack or stroke from the dangerous conditions. Miraculously, he returned to his job as a sales manager that following Tuesday. To Dave Sanderson however, doing the right thing came naturally. When confronting potential tragedy, he remembered the words of his mother, “If you can’t, you must,” and summoned the inner strength to persevere.

Dave grew up in southern Ohio and Winchester, Virginia. He graduated from James Madison University in 1983, being one of the first students to obtain his BBA in the newly formed International Business discipline. Dave's current responsibility is for the sales, management and marketing of Oracle Corporation's applications to the CPG industry segment globally. Mr. Sanderson has over 29 years experience in sales and marketing management with such firms as Marriott, ADP, KPMG, Keane, CIBER and now Oracle.

In his “off time”, Dave has traveled the world with noted author and speaker, Anthony Robbins as his Director of Security. He has been responsible for the areas of Evangelism and Igniting Ministry at Providence United Methodist Church in Charlotte, NC. Dave and his wife Terri—also a graduate of James Madison University—have four children, Chelsey, Colleen, Courtney and Chance. He has spoken to over 450 organizations around the world about his experience and lessons from “The Miracle on the Hudson”.

He currently speaks to organizations around the country about the experience and lessons learned from that day and his experiences after the “Miracle” that can people can apply to their personal and/or business lives. He is a contributor to the book “Brace for Impact” which was released on January 5, 2010. His next book is due to be out in Q2 2014 which is currently titled “Six Minutes”.

## Session E: 9:30 AM – 10:45 AM

---

### **E1: What You Need to Know about Cybersecurity..... Room 405**

*Presented by: Alisha Griswold, Port of Seattle*

With the addition of cybersecurity to FEMA's preparedness rubric (THIRA), the need for an enhanced understanding of digital threats is clear. Join us for a discussion of recent criminal capers, common agency vulnerabilities, and methods of mitigating system compromise. Case studies will cross disciplines and include content appropriate for emergency management, public works, healthcare coalitions, and law enforcement professionals.

### **E2: COOP: From Start to Finish & Back Again ..... Room 317**

*Presented by: Patti Richards, Spokane Regional Health District*

Many agencies are now in the process of developing and/or implementing Continuity of Operation Plans (COOP) to ensure essential functions during emergency and disaster events. According to the Federal Emergency Management Agency (FEMA), a viable continuity of operations capability means that an agency maintains a high level of readiness that can be implemented with or without warning such that essential agency functions can be operational within 12 hours of activation and sustainable for up to 30 days (Federal Emergency Management Agency, 1999). Spokane Regional Health District has developed a COOP plan using a process that involved the participation of all Divisions in the planning for all-hazards. This presentation will walk through the steps of development and the processes used for reviewing, updating and testing the COOP. Tools to promote continuity of operations planning for agencies and ideas for exercises will be shared.

### **E3: Partners in Weather Preparedness: New Technologies You Need to Know .... Room 407**

*Presented by: Ted Buehner, National Weather Service*

This session provides an extension of information presented in the basic session. Topics include:

- How to obtain and use National Weather Service (NWS) all-hazards weather support
- Significant Pacific Northwest weather patterns
- Storm Surveys: what they are, when are they done and the local emergency manager's participation in them
- Washington's Presidentially weather-related disaster rankings and fatality statistics
- How to use the NWS web page such as interpreting the weather radar and satellite imagery, climate/historical data, spotter reports, new digital forecasts and use in your GIS operations (live demo is planned)
- What new or revised technology is available for your use
- StormReady and TsunamiReady communities: what do they mean to you and how to apply and get recognized for the work you do
- Address your questions

The National Weather Service is a partner with the emergency management community in the joint effort to help save lives and property from all-hazards. Look for an interactive and informative session, one that helps answer those questions you've always wanted to ask.

**E4: After the Lessons Are Learned: Effective Improvement Plan Management ..... Room 318**

*Presented by: Ashley Kelmore, Public Health-Seattle & King County*

The HSEEP model for after action reviews necessarily results in the creation of improvement plan items that then need to be incorporated into response plans. Tracking those items and ensuring that the lessons learned are adopted can be a challenge for many reasons; perhaps no one is tasked with the project, everyone is left to their own devices on how to track items, or the items are simply considered complete without confirmation that the relevant plans have been updated.

Public Health – Seattle & King County faced some of these challenges, including unaddressed items dating back four years. This session will share the results of the process Public Health used to reduce the number of outstanding improvement plan items from over 500 to fewer than 100 items in three years. Participants will learn about the system for checking status every six months, bi-annual high-level progress reporting, ways to incorporate items into response plans and a process for ensuring that future improvement plan items are appropriate and able to be completed.

**E5: Building Partnerships between Public Works & Emergency Management ..... Room 407**

*Presented by: Amy Gillespie, Pierce County Department of Emergency Management; Kirk Holmes, Kittitas County Public Works*

This panel will discuss best practices, technological innovations and lessons learned from past incidents. Information shared will demonstrate the importance of having strong partnerships with Public Works and Emergency Management departments.

**E6: Beyond the Buzzword: How to Effectively Collaborate During Disaster Response ..... Room 315**

*Presented by: Lacey Croco, Pepperdine University Graduate Student*

Many disaster response organizations indicate that they collaborate, and most emergency plans create an expectation for collaboration, yet for many this continues to be a challenge during disaster response and is a key item in after-action reports and improvement plans. This presentation will move beyond the buzzword and examine why some disaster response collaborations fail, struggle, or succeed, and will provide a new lens through which to view disaster response collaboration. Combining concepts and experience from the fields of emergency management and organization development, this presentation aims to move the disaster response community closer to effective collaboration in an emergent disaster situation when response organizations have no prior relationship, no authority over each other, and did not plan or expect to work together.



**E7: Practicalities of EM in Incidents & Special Events ..... Room 404**

*Presented by: Scott Preston, University of Washington Emergency Management*

A discussion of the five common challenges in emergency management for incidents and special events and how to mitigate them. Also included will be a discussion on seven signs that your incident is escalating and will require more sophisticated coordination and planning for successful management.

---

## Session F: 11:00 AM – 12:15 PM

---

**F1: Culturally Responsive Emergency Management ..... Room 318**

*Presented by: Sharon Knight, City of Seattle Human Services Department*

Part of serving the whole community in emergency management involves being culturally responsive; providing emergency management services that takes into consideration the “common sense” of the population receiving services. Cultural communities such as hearing impaired, aging, HIV positive, non-English speaking, immigrant, and refugees all have common yet unique needs. Through the analysis and modification of emergency management services, this workshop introduces a universal proactive approach to addressing the unique needs of any given community. This session will introduce culturally responsive emergency management instruments and will focus on Culturally Responsive Emergency Management through self-assessment and service-assessment. This session does not provide legal advice.

**F2: Continuity of Governance:  
Emergency Response Planning for City Legislative Departments ..... Room 404**

*Presented by: Phyllis Shulman & Christie Villa, City of Seattle Legislative Department*

Due to the critical role of the Legislative Department in City government, it must be prepared to continue essential functions during any type of threat, emergency or disaster. The City of Seattle’s Legislative Department will present their comprehensive approach to Continuity of Operations & Government.

- Ensure and validate continuity readiness through a dynamic and integrated continuity Test, Training, and Exercise (TT&E) program. Innovative development of the Employee Handbook, overview of training program and lessons learned. Tools used to help prepare elected officials and staff.
- Maintain control and direction by ensuring essential functions can be performed under all conditions. Multiple simultaneous channels of communication: EOC, Mayor, JIC, elected officials and constituents, and all staff.
- Ensure facilities where it can continue to perform its essential functions and the challenges in location selection; functioning work space while allowing for public access.
- Protect records and assets in the event of a disruption. Identification of supplies needed and how to transport them. Presentation of the Legislative Department “Tool Kit”. How City Clerk ensures all documents created during the activation of the Continuity of Operations plan are maintained and made available to the public.

**F3: ShelterBox Philippines Deployment: Two Deployments in One..... Room 315**

*Presented by: Dave Nichols, Public Health-Seattle & King County / ShelterBox*

Bohol Earthquake & Typhoon Yolanda. Dave will talk about his recent (January 2014) deployment to the Philippines in response to Typhoon Yolanda. He will give insight to an international deployment and what it means for our response to disasters here in the Pacific NW. This will be a quick moving and informative talk which will also give you knowledge of the Charity ShelterBox as well as the extended process their responders go through to qualify.

**F4: Is Your “Whole Community” Ready? ..... Room 405**

*Presented by: Frank Castro-Wehr, Witt O'Brien's; Dr. Ramona Armijo, Disaster Preparedness USA*

This presentation will reveal challenges and best practices for planning a full-scale HSEEP compliant emergency exercise using the “whole community” approach. Presenters will share their experiences related to the breadth of a large mass care and shelter exercise that included offices of emergency services, various county/government departments, fire departments, animal services, hospitals, ambulance companies, a university, private industry, public partners/NGOs, the volunteer community, and populations with access and functional needs. This presentation will reinforce the importance of planning and organizing resources at the local level, while encouraging key leadership to exercise their plans with collaborative partners. Exercise planning with the “whole community” approach helps to establish understandings and agreements that may not have previously existed. The need to support broad community engagement in exercise planning may be evolutionary across the nation, however, the importance of reaching out to under-represented and useful partners in an ongoing basis (year-round) is also encouraged to further promote community resilience.

**F5: I-5 Skagit River Bridge Collapse: A Lesson in Multi-Agency Coordination..... Room 316**

*Presented by: William Lokey, Witt O'Brien's; Mark Watkinson, Skagit County Emergency Management*

This presentation will share the perspective and experience of the initial on-scene public information officer for the I-5 Skagit Bridge Collapse incident. Particular emphasis will be given toward the "if I could do it over again, what would I do better next time" perspective, with specific recommendations for other PIOs that may find themselves in a similar situation one day.

**F6: The Receiving End of the Notification:  
A Change in Perspective from Emergency Manager to Evacuee ..... Room 407**

*Presented by: Lacey Croco, Emergency Management Professional*

When disaster strikes emergency managers generally find themselves coordinating disaster response assistance, not receiving it. This session will examine the lessons that were learned during the historic 2013 Boulder County floods by looking at response and recovery from the perspective of an experienced emergency manager who also happened to be an evacuee. Topics that will be discussed include warning and notification, information during a disaster, volunteers, and the transition from response to recovery.



## F7: Local Emergency Management Program Assessment Tool & WAC 118-30 Updates **Room 317**

*Presented by: Diane Newman, Seattle Office of Emergency Management*

This presentation provides an overview of updates to Washington Administrative Code 118-30, Local Emergency Management/Services Organizations, Plans and Programs as well as the introduction of the Local Emergency Management Program Assessment Tool recently developed by funding provided by the Regional Catastrophic Preparedness Grant Program.

PLENARY SESSION 1:00 PM

## Adrienne Haslet-Davis From Surviving to Thriving: How We Learn to Be Resilient

Boston Marathon Bombing Survivor

**Ballroom**



Adrienne Haslet-Davis has survived the unimaginable bombings at the 2013 Boston Marathon where she lost her left leg below the knee. She is quickly rising to meet her daily challenges head on with a unique perspective. Being a ballroom dancer and former Fortune 500 corporate manager, at the peak of her career, she has had to learn an entirely new meaning to the word patience.

In the wake of the marathon, she has become an inspiration through her positive attitude and infectious smile. She has recently returned to the dance floor and is ready to take on the challenge of relearning head-on. Appearing on *CNN*, *Dancing With The Stars*, *The View* and many other media outlets, Adrienne hopes her emotional honesty will serve as an example to others looking to overcome adversity in their own lives.

She has inspired John Hancock corporate runners in the 2014 Boston Marathon, Merrill Lynch corporate meetings and many others.

Adrienne accepted a 2013 Med Star Gala Victory Award in Washington DC and was honored with her first responders at the 2013 Schwartz Center Gala in Boston.

She was recently named one of *Cosmo's Most Powerful Women of 2013*. She is a born storyteller and enjoys teaching others that they too, have an inner strength that is larger than life itself.

# SPONSOR Advertisements

*Thank You to Our  
2014 Sponsors!*

Seattle  
 Public  
Utilities

## Booth 30



## Booth 17



*Visit us at the  
Partners in Emergency  
Preparedness Conference  
Booth #17*



Preparation is the key to any organization's success. Witt O'Brien's offers a complete range of planning, mitigation, and prevention services to better prepare your organization before a crisis happens. Witt O'Brien's works with clients to take an all-hazards approach to ensure that public, private, and non-governmental organizations are fully prepared to meet the challenges of crisis and disasters of any kind.

**WITT O'BRIEN'S**  
CONTROL THE OUTCOME®  
[www.wittobriens.com](http://www.wittobriens.com)

PREPARE | RESPOND | COMMUNICATE | RECOVER

# SPONSOR Advertisements

## Booth 24

### NETWORKED FOR LIFE

Northeastern University—Seattle offers 30 industry-focused graduate programs, including our comprehensive **Master of Arts in Homeland Security** Program.

Learn more today at: [northeastern.edu/seattle](http://northeastern.edu/seattle)

Northeastern University  
Seattle



## Booth 32

### ARE YOU READY?

At Takouba, our experts uncover and reduce vulnerabilities with an eye to creating carefully crafted response plans. Our training, computer simulations and real-life exercises are built to help your organization to avert or work through the uncertainties of a crisis.

When disaster strikes, be prepared.

To learn more, give us a call at **253.722.5877** or visit [takoubasecurity.com](http://takoubasecurity.com).



## Booth 27



OCTOBER 16, 2014

@ 10:16 a.m.

Earthquake Drill



Tsunami Siren Test



Registration/Information: [www.shakeout.org/washington](http://www.shakeout.org/washington)

## Booth 7



Caring for our friends and neighbors — that's myPSE



## Booth 3

**WSEMA is the professional association of local, county, tribal, state and federal emergency management individuals from the private and public sectors committed to:**

- 1 Providing state leadership and expertise in comprehensive emergency management
- 2 Serving as a vital information and assistance resource for local, county, tribal, and state managers and directors, and private industry
- 3 Forging strategic partnerships to advance continuous improvement in emergency management



We invite you to visit our sponsors and exhibit booths located in the 3rd floor foyer.

# FACILITY & Exhibitor Layout

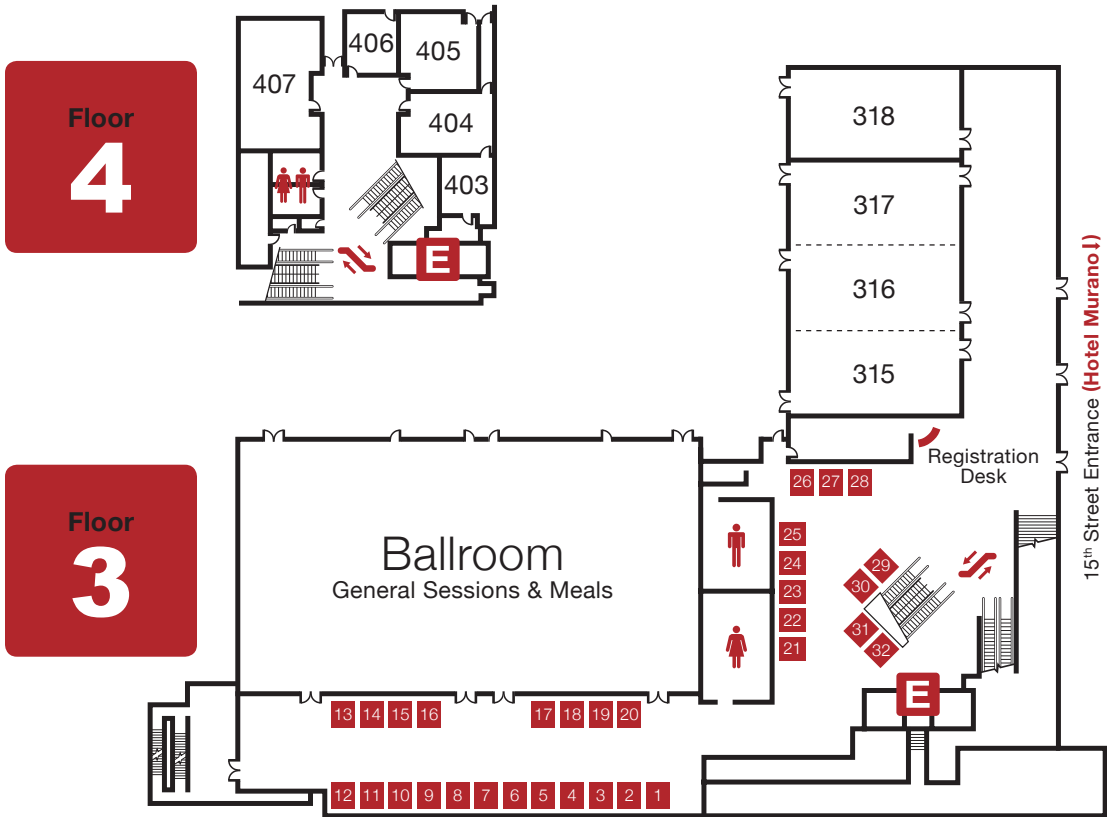

- |   |  |   |
|---|--|---|
| <b>1</b> Center for Domestic Preparedness                             | <b>13</b> Deployed Logix                     | <b>24</b> Northeastern University-Seattle*  |
| <b>2</b> National Network of Libraries of Medicine, Pacific NW Region | <b>14</b> Western Shelter Systems            | <b>25</b> QuakeHOLD! Industrial             |
| <b>3</b> WSEMA*   | <b>15</b> Partners In Emergency Preparedness | <b>26</b> Legend ID and IMS Alliance        |
| <b>4</b> Pierce College   | <b>16</b> Wilson Safety                      | <b>27</b> Washington State EMD*             |
| <b>5</b> Big Blok, LLC  | <b>17</b> Witt O'Brien's*                    | <b>28</b> Simpler Life Emergency Provisions |
| <b>6</b> Ecology and Environment, Inc.                                | <b>18</b> Trident University                 | <b>29</b> THRIVE Life                       |
| <b>7</b> Puget Sound Energy*  | <b>19</b> TierPoint                          | <b>30</b> Verizon Wireless*                 |
| <b>8</b> AlertSense   | <b>20</b> ProPac                             | <b>31</b> Reid Middleton, Inc.              |
| <b>9</b> Recovers   | <b>21</b> Alster Communications              | <b>32</b> Takouba Security, LLC*            |
| <b>12</b> BELFOR Property Restoration                                 | <b>22</b> PrepareSmart, LLC                  |   |
|   | <b>23</b> OCENS                              |   |

*\*Conference Sponsor*

# CONFERENCE Exhibitors



## Center for Domestic Preparedness

### Booth #1

Jennifer McCullars  
cdp.dhs.gov  
866-213-9553

The CDP develops and delivers training for emergency response providers from state, local, and tribal governments and, when appropriate, the federal government, foreign governments, and private entities.

## National Network of Libraries of Medicine, Pacific NW Region

### Booth #2

Gail Kouame  
gmarie@uw.edu  
nmlm.gov/pnr  
206-221-3449

The National Library of Medicine hosts the Disaster Information Management Resource Center (<http://disaster.nlm.nih.gov>) as well as other online resources relevant to emergency preparedness and response. Come visit us at Booth #2 to speak with librarian specialists and see the resources demonstrated. Many of the resources are also available for mobile devices—your emergency go bag!

## WSEMA

### Booth #3

Butch Aiken  
butchacdem@clarkston.com  
www.wsema.com  
509-780-7225

The purpose of the Association shall be to promote emergency preparedness throughout the state of Washington. To accomplish this, the Association shall endeavor to:

- Enhance emergency public education.
- Encourage emergency planning and preparedness.
- Provide training and professional development.
- Improve coordination and communications in the emergency management community.

## Pierce College

### Booth #4

Kellie Hale  
KHale@pierce.ctc.edu  
www.pierce.ctc.edu  
253-912-3689

Center for Excellence Homeland Security/Emergency Management/serves as lead for the coalition of all 34 Washington State Community & Technical Colleges. Facilitates training and education to colleges, public/private organizations & community.

## Big Blok, LLC

### Booth #5

Greg Nuber  
bigblokgn@live.com  
www.bigblok.com  
360-442-0655

New, innovative design in emergency preparedness containers for home and business.

## Ecology and Environment, Inc.

### Booth #6

Matthew Lieuallen  
mlieuallen@ene.com  
www.ene.com  
503-248-5600

E & E is a full-service, multi-discipline environmental and emergency management consulting firm. We provide comprehensive emergency management services, including innovative and collaborative planning, training, and exercise services; response and recovery support; and assistance in incorporating sustainability into emergency management program development. E & E has a strong Northwest presence with offices in Anchorage, Seattle, and Portland that are supported by a nationwide network of emergency management professionals. We pride ourselves on providing a client-centered approach to emergency planning and stand ready to assist you in building a more resilient Northwest.

# CONFERENCE Exhibitors

## Puget Sound Energy

### Booth #7

Lynn Murphy  
lynn.murphy@pse.com  
www.pse.com  
360-766-5509

Puget Sound Energy has been meeting the Puget Sound region's energy needs for more than 135 years. We proudly embrace our responsibility to provide you with safe reliable reasonably priced energy service.

## AlertSense

### Booth #8

Jim Borchers  
jimborchers@AlertSense.com  
www.AlertSense.com  
208-639-6757

AlertSense provides mass and emergency communication services including Geo Targeted land-line, Wireless Emergency Alerts (WEA), Internal notification and callouts; public opt in notification; Emergency Alert System (EAS); and all other public and private alerting.

## Recovers

### Booth #9

Chris Kuryak  
chris@recovers.org  
www.recovers.org  
512-632-5144

Recovers makes disaster preparedness and recovery smarter. Used during Hurricane Sandy and the Oklahoma tornadoes, our easy-to-use software reduces the workload of government agencies by empowering organizations and residents to prepare together, work efficiently, and recover faster.

## BELFOR Property Restoration

### Booth #12

Alicia Cole  
alicia.cole@us.belfor.com  
www.belfor.com  
509-995-3649

Providing Single-Source Recovery Solutions 24/7. Wind, Water, Fire & Disaster Recovery.

## Deployed Logix

### Booth #13

Adam Barr  
Abarr@deployedlogix.com  
www.deployedlogix.com  
541-514-1843

Field Operations. Mobile Shelters. Deployments.

## Western Shelter Systems

### Booth #14

Anthony Petrone  
apetrone@westernshelter.com  
www.westernshelter.com  
719-225-3261

The Western Shelter system was designed to provide an easily transported, simple to erect, and, most importantly, weather-secure working environment for operations in remote locations. From the arctic to the tropics, the proven reliability of our designs, material, and construction has consistently exceeded customer expectations in the harshest of conditions. Performance under these critical conditions has brought our Western Shelter product line to the attention of agencies and organizations in the fire, rescue, medical, military, and disaster response fields. Since 1992, Western Shelter Systems has been the standard, exclusive supplier of re-deployable shelters for all US Federal government FEMA emergency responder teams, state and county governments, and municipal fire and police jurisdictions; as well as forest service, military, hospital, and industrial organizations.

# CONFERENCE Exhibitors



## Wilson Safety

### Booth #16

Linda Perry  
lindap@wilsonirr.com  
www.iwilson.com/safetyservices  
509-901-1662

Distributor of automated external defibrillators (AED's) & accessories, evacuation plans, CPR classes.

## Witt O'Brien's

### Booth #17

Kerri Howell  
Khowell@wittobriens.com  
www.wittobriens.com  
281-606-4716

Witt O'Brien's is a global leader in preparedness, crisis management and disaster response and recovery with the depth of experience and capability to provide services across the crisis and disaster life cycle. Witt O'Brien's is uniquely positioned to bring together policy architects and technical experts in public safety, with leaders from all levels of government and private sector partners to forge solutions to emergency management challenges.

## Trident University

### Booth #18

Kevin Johnson  
Paul.Nelson@Trident.edu  
www.trident.edu  
714-229-7003 or 800-451-2269

Trident University International is committed to developing a passionate, connected learning community that helps students and organizations achieve their academic and professional goals. Trident is a Regionally Accredited university that adheres to all U.S. Department of Education and WASC standards. Our 100% online programs feature 15 degrees and over 80 concentrations. Delivered by a highly qualified academic faculty, of which over 90% hold Doctoral degrees, quality instruction is combined with real world experience. Trident University welcomes you to explore the pos-

sibilities of taking your individual or organizational academic journey with Trident... take command of your future today!

## TierPoint

### Booth #19

Dan Golden  
dan.golden@tierpoint.com  
www.tierpoint.com  
206-404-9003

TierPoint is a leading provider of cloud, colocation and managed services designed to help organizations improve business performance and manage risk. With corporate headquarters in St. Louis, TierPoint operates six state-of-the-art data centers in Baltimore, Dallas, Oklahoma City, Spokane, Seattle and Tulsa. The company provides comprehensive data center solutions backed by the expertise of industry veterans.

## ProPac

### Booth #20

Richard King  
propac@propacusa.com  
www.propacusa.com  
800-345-3036

Disaster Preparedness and Relief

## Alster Communications

### Booth #21

Kim Torp-Pedersen  
kimtp@aol.com  
www.alster.com  
425-702-8396

Manufacturers representative for Federal warning systems for public outdoor warning and mass notification.

# CONFERENCE Exhibitors

## PrepareSmart, LLC

### Booth #22

Keith Oratz  
keitho@preparesmart.com  
www.preparesmart.com  
425-881-5354

PrepareSmart is one of the country's leading suppliers of emergency preparedness kits and supplies. The staff is CERT (Community Emergency Response Teams) trained and very active in the national CERT program. We provide standard and customized kits to CERT and MRC (Medical Reserve Corps) teams and users across the country. Members of our staff are also Citizen Corps leaders as well as being PTSA Emergency Preparedness Coordinators for Primary and Secondary Schools. Our company was founded to help individuals, schools, businesses and other organizations become better prepared in the event of an emergency. We provide innovative, high quality and cost effective safety and emergency preparedness supplies and services as well as assisting with school and non-profit fundraising programs. Our preparedness offerings range from single person kits perfect for vehicles to family kits for up to five people. We can also custom design kits for offices and groups of all sizes.

## OCENS

### Booth #23

Matt Haase  
matt@ocens.com  
www.ocens.com  
206-878-8270

OCENS specializes in satellite communications and provides disaster recovery and business continuity solutions for backup voice, internet, and email service. Because the technology is satellite based, it is unaffected by localized events and will be available when your primary connections fail. Kits are compact, mobile, and completely self-contained in a Pelican case that includes backup power and solar charging. Multiple voice line options are also available. The communications systems are designed to be used on-demand, so monthly subscription costs are minimal.

## Northeastern University-Seattle

### Booth #24

Stephanie Pure  
s.pure@neu.edu  
www.northeastern.edu/seattle  
206-291-5201

Founded in 1898, Northeastern University is a top-tier, non-profit, private research university and a leader in global experiential learning that integrates rigorous classroom learning with real-world professional experience. Based in Boston, MA, Northeastern has two graduate campuses in Seattle, WA and Charlotte, NC offering highly flexible courses in a variety of master's degree and doctoral programs in high-demand areas. The graduate degrees in these academic hubs are aligned with their regions' educational, workforce, and economic development needs, including programs in emerging fields, such as information assurance, project management and our newest program, the Master of Arts in Homeland Security. The graduate campuses also serve as platforms for research partnerships among the university and regional industries, public agencies, and academic institutions. For more information about Northeastern University—Seattle, visit [www.northeastern.edu/seattle](http://www.northeastern.edu/seattle)

## QuakeHOLD! Industrial

### Booth #25

Tom Woertz  
tomw@quakeholdindustrial.com  
www.quakeholdindustrial.com  
800-959-4053

QuakeHOLD! Industrial is the leader in non-structural seismic mitigation. We have more than 50 years of combined experience including hospital and lab fastening, data center mitigation and more. Our innovative countertop fasteners, and lab restraints protect employees from seismic risks within the workplace. We also provide emergency response trailers and emergency kits and supplies for all sizes of groups and individuals.



# CONFERENCE Exhibitors



## Legend ID & IMS Alliance

### Booth #26

Zach Walker  
monica@legendid.com  
www.legendid.com  
425-251-1670

Legend ID: Legend Data Systems, Inc. dba Legend ID was formed in 1989 as the regional reseller of Datacard Corporation embossing, imprinting and photo identification systems. The company has expanded its vendor agreements to include the best manufacturers of hardware and software in the identification industry. Legend ID uniquely provides on-site installation, training and maintenance for all of the products we sell. We are factory authorized service providers. Legend ID provides preprinted proximity cards, smart card solutions and proximity cards. We are an authorized dealer for HID and Ingersol Rand/XceedID. We have the largest card printing Service Bureau in the northwest, with complete fulfillment of over a million cards per year. IMS Alliance: IMS Alliance is a providers of incident command boards; HICS boards for Hospitals, Law Enforcement boards, ARFF boards, School Safety & Security, and more.

## Washington State EMD

### Booth #27

Lit Dudley  
lit.dudley@mil.wa.gov  
www.emd.wa.gov  
253-512-7440

The Washington State Emergency Management Division (EMD) is one of four major operational divisions in the Washington Military Department. The mission of the division is to minimize the impact of emergencies and disasters on the people, property, and environment of Washington State. The Division supports this mission with 80 full time agency employees and an additional 20 to 50 project employees who are employed for disaster recovery and homeland security projects. During disasters the Division brings on board an additional 40 to more than 200 staff from other state agencies federal agency representatives and private organizations to manage disaster re-

covery activities. The Division provides oversight on 18 diverse EMD programs and manages \$118 million in federal grant funds that fund emergency management activities statewide.

## Simpler Life Emergency Provisions

### Booth #28

Bob Snedaker  
sales@simplerlife.com  
www.simplerlife.com  
800-266-7737

For more than 32 years, Simpler Life has been equipping America's businesses, government agencies, hospitals and healthcare providers, schools, their staff and families with strong proven Disaster and Disaster Specialty kits, bulk supplies, and Life Saving Equipment. Come and visit us in our usual booth location for a special gift and learn what is new in meeting "our basic needs" during difficult days.

## THRIVE Life

### Booth #29

Bob Richardson  
debbie@morethrive.com  
www.thrivelife.com  
360-509-8001

Thrive Life sells Freeze Dried Foods with a 25 year shelf life. They have no additives or preservatives and are GMO Free. We sell lots of Emergency preparedness products.

## Verizon

### Booth #30

Tom Serio  
Tom.Serio@VerizonWireless.com  
www.verizonwireless.com  
561-995-5677

Connecting at the Speed of Life. Every day, we connect people, companies and communities with powerful technology, enabling the convenience of mobile services when and where our customers want it. Verizon Wireless. "Welcome to connected living."

# CONFERENCE Exhibitors

## Reid Middleton, Inc.

### Booth #31

Ben Llanes  
bllanes@reidmiddleton.com  
www.reidmiddleton.com  
425-741-5016

Since 1953, Reid Middleton, Inc., has worked throughout the Pacific Northwest, Alaska, and California to provide civil and structural engineering, planning and permitting, and surveying services to public and private sector clients. Our multidisciplinary capabilities expand to include work for cities, counties, private companies, state and federal agencies and special-purpose districts. Reid Middleton teams specialize in designing and managing projects in aviation, military, public works, commercial and industrial, state and institutional, and waterfront areas. Public safety is a defining passion of Reid Middleton engineers. Understanding the value to the engineering profession by investigating earthquakes worldwide, Reid Middleton regularly organizes and leads post-earthquake reconnaissance teams to learn how to better design buildings, bridges and infrastructure. Our engineers have first-hand experience with understanding how building and infrastructure behave under extreme events such as earthquakes, wind storms, heavy rains and snow, and floods.

## Takouba

### Booth #32

James Rollins  
james.m.rollins@takoubasecurity.com  
www.takoubasecurity.com  
425-919-5153

Today, Fortune 500 companies must be equipped to handle the risks posed by nature and other unforeseen threats. Takouba is here to help them prepare, respond with confidence and quickly recover. When working with us, businesses will understand and reduce their unique vulnerabilities. We partner to develop predictive intelligence, create effective response plans, and administer custom staffing programs built for all contingencies. We then provide the training and emergency exercises needed to avert or confidently work through uncertainties of a crisis and restore a business to peak efficiency. Takouba is a veteran-owned and operated business.

# EVALUATION Sandi Doughton



Please use the following as a guide to take notes on this session. You will be invited to submit an online evaluation following the conference.

	Strongly Agree	Agree	Disagree	Strongly Disagree	N/A
The <u>session title</u> accurately conveyed its content.	<input type="radio"/>	<input type="radio"/>	<input type="radio"/>	<input type="radio"/>	<input type="radio"/>
The <u>session description</u> accurately conveyed its content.	<input type="radio"/>	<input type="radio"/>	<input type="radio"/>	<input type="radio"/>	<input type="radio"/>
The content of the session was useful.	<input type="radio"/>	<input type="radio"/>	<input type="radio"/>	<input type="radio"/>	<input type="radio"/>
Given the time available, the amount of material covered was appropriate.	<input type="radio"/>	<input type="radio"/>	<input type="radio"/>	<input type="radio"/>	<input type="radio"/>
Overall, I am satisfied with this session.	<input type="radio"/>	<input type="radio"/>	<input type="radio"/>	<input type="radio"/>	<input type="radio"/>
I would recommend this session to my colleagues.	<input type="radio"/>	<input type="radio"/>	<input type="radio"/>	<input type="radio"/>	<input type="radio"/>
The presenter(s) knowledge of the subject was apparent.	<input type="radio"/>	<input type="radio"/>	<input type="radio"/>	<input type="radio"/>	<input type="radio"/>
The presenter(s) presented the material in an organized way.	<input type="radio"/>	<input type="radio"/>	<input type="radio"/>	<input type="radio"/>	<input type="radio"/>
The handouts/materials I received were useful.	<input type="radio"/>	<input type="radio"/>	<input type="radio"/>	<input type="radio"/>	<input type="radio"/>
Appropriate audiovisuals were used during the presentation.	<input type="radio"/>	<input type="radio"/>	<input type="radio"/>	<input type="radio"/>	<input type="radio"/>
I would strongly recommend the presenter to be invited to conduct this session again.	<input type="radio"/>	<input type="radio"/>	<input type="radio"/>	<input type="radio"/>	<input type="radio"/>

Notes \_\_\_\_\_

\_\_\_\_\_

\_\_\_\_\_

\_\_\_\_\_

\_\_\_\_\_

\_\_\_\_\_

\_\_\_\_\_

\_\_\_\_\_

\_\_\_\_\_

\_\_\_\_\_

# EVALUATION **David Sanderson**

Please use the following as a guide to take notes on this session. You will be invited to submit an online evaluation following the conference.

	Strongly Agree	Agree	Disagree	Strongly Disagree	N/A
The <u>session title</u> accurately conveyed its content.	<input type="radio"/>	<input type="radio"/>	<input type="radio"/>	<input type="radio"/>	<input type="radio"/>
The <u>session description</u> accurately conveyed its content.	<input type="radio"/>	<input type="radio"/>	<input type="radio"/>	<input type="radio"/>	<input type="radio"/>
The content of the session was useful.	<input type="radio"/>	<input type="radio"/>	<input type="radio"/>	<input type="radio"/>	<input type="radio"/>
Given the time available, the amount of material covered was appropriate.	<input type="radio"/>	<input type="radio"/>	<input type="radio"/>	<input type="radio"/>	<input type="radio"/>
Overall, I am satisfied with this session.	<input type="radio"/>	<input type="radio"/>	<input type="radio"/>	<input type="radio"/>	<input type="radio"/>
I would recommend this session to my colleagues.	<input type="radio"/>	<input type="radio"/>	<input type="radio"/>	<input type="radio"/>	<input type="radio"/>
The presenter(s) knowledge of the subject was apparent.	<input type="radio"/>	<input type="radio"/>	<input type="radio"/>	<input type="radio"/>	<input type="radio"/>
The presenter(s) presented the material in an organized way.	<input type="radio"/>	<input type="radio"/>	<input type="radio"/>	<input type="radio"/>	<input type="radio"/>
The handouts/materials I received were useful.	<input type="radio"/>	<input type="radio"/>	<input type="radio"/>	<input type="radio"/>	<input type="radio"/>
Appropriate audiovisuals were used during the presentation.	<input type="radio"/>	<input type="radio"/>	<input type="radio"/>	<input type="radio"/>	<input type="radio"/>
I would strongly recommend the presenter to be invited to conduct this session again.	<input type="radio"/>	<input type="radio"/>	<input type="radio"/>	<input type="radio"/>	<input type="radio"/>

Notes \_\_\_\_\_

\_\_\_\_\_

\_\_\_\_\_

\_\_\_\_\_

\_\_\_\_\_

\_\_\_\_\_

\_\_\_\_\_

\_\_\_\_\_

\_\_\_\_\_

\_\_\_\_\_

# EVALUATION **Adrienne Haslet-Davis**



Please use the following as a guide to take notes on this session. You will be invited to submit an online evaluation following the conference.

	Strongly Agree	Agree	Disagree	Strongly Disagree	N/A
The <u>session title</u> accurately conveyed its content.	<input type="radio"/>	<input type="radio"/>	<input type="radio"/>	<input type="radio"/>	<input type="radio"/>
The <u>session description</u> accurately conveyed its content.	<input type="radio"/>	<input type="radio"/>	<input type="radio"/>	<input type="radio"/>	<input type="radio"/>
The content of the session was useful.	<input type="radio"/>	<input type="radio"/>	<input type="radio"/>	<input type="radio"/>	<input type="radio"/>
Given the time available, the amount of material covered was appropriate.	<input type="radio"/>	<input type="radio"/>	<input type="radio"/>	<input type="radio"/>	<input type="radio"/>
Overall, I am satisfied with this session.	<input type="radio"/>	<input type="radio"/>	<input type="radio"/>	<input type="radio"/>	<input type="radio"/>
I would recommend this session to my colleagues.	<input type="radio"/>	<input type="radio"/>	<input type="radio"/>	<input type="radio"/>	<input type="radio"/>
The presenter(s) knowledge of the subject was apparent.	<input type="radio"/>	<input type="radio"/>	<input type="radio"/>	<input type="radio"/>	<input type="radio"/>
The presenter(s) presented the material in an organized way.	<input type="radio"/>	<input type="radio"/>	<input type="radio"/>	<input type="radio"/>	<input type="radio"/>
The handouts/materials I received were useful.	<input type="radio"/>	<input type="radio"/>	<input type="radio"/>	<input type="radio"/>	<input type="radio"/>
Appropriate audiovisuals were used during the presentation.	<input type="radio"/>	<input type="radio"/>	<input type="radio"/>	<input type="radio"/>	<input type="radio"/>
I would strongly recommend the presenter to be invited to conduct this session again.	<input type="radio"/>	<input type="radio"/>	<input type="radio"/>	<input type="radio"/>	<input type="radio"/>

Notes \_\_\_\_\_

\_\_\_\_\_

\_\_\_\_\_

\_\_\_\_\_

\_\_\_\_\_

\_\_\_\_\_

\_\_\_\_\_

\_\_\_\_\_

\_\_\_\_\_

\_\_\_\_\_

# EVALUATION *Session A*

Please use the following as a guide to take notes on this session. You will be invited to submit an online evaluation following the conference.

Title \_\_\_\_\_

Session # \_\_\_\_\_ Presenter \_\_\_\_\_

	Strongly Agree	Agree	Disagree	Strongly Disagree	N/A
The <u>session title</u> accurately conveyed its content.	<input type="radio"/>	<input type="radio"/>	<input type="radio"/>	<input type="radio"/>	<input type="radio"/>
The <u>session description</u> accurately conveyed its content.	<input type="radio"/>	<input type="radio"/>	<input type="radio"/>	<input type="radio"/>	<input type="radio"/>
The content of the session was useful.	<input type="radio"/>	<input type="radio"/>	<input type="radio"/>	<input type="radio"/>	<input type="radio"/>
Given the time available, the amount of material covered was appropriate.	<input type="radio"/>	<input type="radio"/>	<input type="radio"/>	<input type="radio"/>	<input type="radio"/>
Overall, I am satisfied with this session.	<input type="radio"/>	<input type="radio"/>	<input type="radio"/>	<input type="radio"/>	<input type="radio"/>
I would recommend this session to my colleagues.	<input type="radio"/>	<input type="radio"/>	<input type="radio"/>	<input type="radio"/>	<input type="radio"/>
The presenter(s) knowledge of the subject was apparent.	<input type="radio"/>	<input type="radio"/>	<input type="radio"/>	<input type="radio"/>	<input type="radio"/>
The presenter(s) presented the material in an organized way.	<input type="radio"/>	<input type="radio"/>	<input type="radio"/>	<input type="radio"/>	<input type="radio"/>
The handouts/materials I received were useful.	<input type="radio"/>	<input type="radio"/>	<input type="radio"/>	<input type="radio"/>	<input type="radio"/>
Appropriate audiovisuals were used during the presentation.	<input type="radio"/>	<input type="radio"/>	<input type="radio"/>	<input type="radio"/>	<input type="radio"/>
I would strongly recommend the presenter to be invited to conduct this session again.	<input type="radio"/>	<input type="radio"/>	<input type="radio"/>	<input type="radio"/>	<input type="radio"/>

Notes \_\_\_\_\_

---



---



---



---



---



---



---



---



---

# EVALUATION *Session B*

Please use the following as a guide to take notes on this session. You will be invited to submit an online evaluation following the conference.

Title \_\_\_\_\_

Session # \_\_\_\_\_ Presenter \_\_\_\_\_

	Strongly Agree	Agree	Disagree	Strongly Disagree	N/A
The <u>session title</u> accurately conveyed its content.	<input type="radio"/>	<input type="radio"/>	<input type="radio"/>	<input type="radio"/>	<input type="radio"/>
The <u>session description</u> accurately conveyed its content.	<input type="radio"/>	<input type="radio"/>	<input type="radio"/>	<input type="radio"/>	<input type="radio"/>
The content of the session was useful.	<input type="radio"/>	<input type="radio"/>	<input type="radio"/>	<input type="radio"/>	<input type="radio"/>
Given the time available, the amount of material covered was appropriate.	<input type="radio"/>	<input type="radio"/>	<input type="radio"/>	<input checked="" type="radio"/>	<input type="radio"/>
Overall, I am satisfied with this session.	<input type="radio"/>	<input type="radio"/>	<input type="radio"/>	<input type="radio"/>	<input type="radio"/>
I would recommend this session to my colleagues.	<input type="radio"/>	<input type="radio"/>	<input type="radio"/>	<input type="radio"/>	<input type="radio"/>
The presenter(s) knowledge of the subject was apparent.	<input type="radio"/>	<input type="radio"/>	<input type="radio"/>	<input type="radio"/>	<input type="radio"/>
The presenter(s) presented the material in an organized way.	<input type="radio"/>	<input type="radio"/>	<input type="radio"/>	<input type="radio"/>	<input type="radio"/>
The handouts/materials I received were useful.	<input type="radio"/>	<input type="radio"/>	<input type="radio"/>	<input type="radio"/>	<input type="radio"/>
Appropriate audiovisuals were used during the presentation.	<input type="radio"/>	<input type="radio"/>	<input type="radio"/>	<input type="radio"/>	<input type="radio"/>
I would strongly recommend the presenter to be invited to conduct this session again.	<input type="radio"/>	<input type="radio"/>	<input type="radio"/>	<input type="radio"/>	<input type="radio"/>

Notes \_\_\_\_\_  
 \_\_\_\_\_  
 \_\_\_\_\_  
 \_\_\_\_\_  
 \_\_\_\_\_  
 \_\_\_\_\_  
 \_\_\_\_\_  
 \_\_\_\_\_

# EVALUATION *Session C*

Please use the following as a guide to take notes on this session. You will be invited to submit an online evaluation following the conference.

Title \_\_\_\_\_

Session # \_\_\_\_\_ Presenter \_\_\_\_\_

	Strongly Agree	Agree	Disagree	Strongly Disagree	N/A
The <u>session title</u> accurately conveyed its content.	<input type="radio"/>	<input type="radio"/>	<input type="radio"/>	<input type="radio"/>	<input type="radio"/>
The <u>session description</u> accurately conveyed its content.	<input type="radio"/>	<input type="radio"/>	<input type="radio"/>	<input type="radio"/>	<input type="radio"/>
The content of the session was useful.	<input type="radio"/>	<input type="radio"/>	<input type="radio"/>	<input type="radio"/>	<input type="radio"/>
Given the time available, the amount of material covered was appropriate.	<input type="radio"/>	<input type="radio"/>	<input type="radio"/>	<input checked="" type="radio"/>	<input type="radio"/>
Overall, I am satisfied with this session.	<input type="radio"/>	<input checked="" type="radio"/>	<input type="radio"/>	<input checked="" type="radio"/>	<input type="radio"/>
I would recommend this session to my colleagues.	<input type="radio"/>	<input type="radio"/>	<input type="radio"/>	<input type="radio"/>	<input type="radio"/>
The presenter(s) knowledge of the subject was apparent.	<input type="radio"/>	<input type="radio"/>	<input type="radio"/>	<input type="radio"/>	<input type="radio"/>
The presenter(s) presented the material in an organized way.	<input type="radio"/>	<input type="radio"/>	<input type="radio"/>	<input type="radio"/>	<input type="radio"/>
The handouts/materials I received were useful.	<input type="radio"/>	<input type="radio"/>	<input type="radio"/>	<input type="radio"/>	<input type="radio"/>
Appropriate audiovisuals were used during the presentation.	<input type="radio"/>	<input type="radio"/>	<input type="radio"/>	<input type="radio"/>	<input type="radio"/>
I would strongly recommend the presenter to be invited to conduct this session again.	<input type="radio"/>	<input type="radio"/>	<input type="radio"/>	<input type="radio"/>	<input type="radio"/>

Notes \_\_\_\_\_

---



---



---



---



---



---



---



---



# EVALUATION *Session D*

Please use the following as a guide to take notes on this session. You will be invited to submit an online evaluation following the conference.

Title \_\_\_\_\_

Session # \_\_\_\_\_ Presenter \_\_\_\_\_

	Strongly Agree	Agree	Disagree	Strongly Disagree	N/A
The <u>session title</u> accurately conveyed its content.	<input type="radio"/>	<input type="radio"/>	<input type="radio"/>	<input type="radio"/>	<input type="radio"/>
The <u>session description</u> accurately conveyed its content.	<input type="radio"/>	<input type="radio"/>	<input type="radio"/>	<input type="radio"/>	<input type="radio"/>
The content of the session was useful.	<input type="radio"/>	<input type="radio"/>	<input type="radio"/>	<input type="radio"/>	<input type="radio"/>
Given the time available, the amount of material covered was appropriate.	<input type="radio"/>	<input type="radio"/>	<input type="radio"/>	<input checked="" type="radio"/>	<input type="radio"/>
Overall, I am satisfied with this session.	<input type="radio"/>	<input type="radio"/>	<input type="radio"/>	<input type="radio"/>	<input type="radio"/>
I would recommend this session to my colleagues.	<input type="radio"/>	<input type="radio"/>	<input type="radio"/>	<input type="radio"/>	<input type="radio"/>
The presenter(s) knowledge of the subject was apparent.	<input type="radio"/>	<input type="radio"/>	<input type="radio"/>	<input type="radio"/>	<input type="radio"/>
The presenter(s) presented the material in an organized way.	<input type="radio"/>	<input type="radio"/>	<input type="radio"/>	<input type="radio"/>	<input type="radio"/>
The handouts/materials I received were useful.	<input type="radio"/>	<input type="radio"/>	<input type="radio"/>	<input type="radio"/>	<input type="radio"/>
Appropriate audiovisuals were used during the presentation.	<input type="radio"/>	<input type="radio"/>	<input type="radio"/>	<input type="radio"/>	<input type="radio"/>
I would strongly recommend the presenter to be invited to conduct this session again.	<input type="radio"/>	<input type="radio"/>	<input type="radio"/>	<input type="radio"/>	<input type="radio"/>

Notes \_\_\_\_\_

---



---



---



---



---



---



---



---

# EVALUATION *Session E*

Please use the following as a guide to take notes on this session. You will be invited to submit an online evaluation following the conference.

Title \_\_\_\_\_

Session # \_\_\_\_\_ Presenter \_\_\_\_\_

	Strongly Agree	Agree	Disagree	Strongly Disagree	N/A
The <u>session title</u> accurately conveyed its content.	<input type="radio"/>	<input type="radio"/>	<input type="radio"/>	<input type="radio"/>	<input type="radio"/>
The <u>session description</u> accurately conveyed its content.	<input type="radio"/>	<input type="radio"/>	<input type="radio"/>	<input type="radio"/>	<input type="radio"/>
The content of the session was useful.	<input type="radio"/>	<input type="radio"/>	<input type="radio"/>	<input type="radio"/>	<input type="radio"/>
Given the time available, the amount of material covered was appropriate.	<input type="radio"/>	<input type="radio"/>	<input type="radio"/>	<input type="radio"/>	<input type="radio"/>
Overall, I am satisfied with this session.	<input type="radio"/>	<input type="radio"/>	<input type="radio"/>	<input type="radio"/>	<input type="radio"/>
I would recommend this session to my colleagues.	<input type="radio"/>	<input type="radio"/>	<input type="radio"/>	<input type="radio"/>	<input type="radio"/>
The presenter(s) knowledge of the subject was apparent.	<input type="radio"/>	<input type="radio"/>	<input type="radio"/>	<input type="radio"/>	<input type="radio"/>
The presenter(s) presented the material in an organized way.	<input type="radio"/>	<input type="radio"/>	<input type="radio"/>	<input type="radio"/>	<input type="radio"/>
The handouts/materials I received were useful.	<input type="radio"/>	<input type="radio"/>	<input type="radio"/>	<input type="radio"/>	<input type="radio"/>
Appropriate audiovisuals were used during the presentation.	<input type="radio"/>	<input type="radio"/>	<input type="radio"/>	<input type="radio"/>	<input type="radio"/>
I would strongly recommend the presenter to be invited to conduct this session again.	<input type="radio"/>	<input type="radio"/>	<input type="radio"/>	<input type="radio"/>	<input type="radio"/>

Notes \_\_\_\_\_

---



---



---



---



---



---



---



---

# EVALUATION *Session F*



Please use the following as a guide to take notes on this session. You will be invited to submit an online evaluation following the conference.

Title \_\_\_\_\_

Session # \_\_\_\_\_ Presenter \_\_\_\_\_

	Strongly Agree	Agree	Disagree	Strongly Disagree	N/A
The <u>session title</u> accurately conveyed its content.	<input type="radio"/>	<input type="radio"/>	<input type="radio"/>	<input type="radio"/>	<input type="radio"/>
The <u>session description</u> accurately conveyed its content.	<input type="radio"/>	<input type="radio"/>	<input type="radio"/>	<input type="radio"/>	<input type="radio"/>
The content of the session was useful.	<input type="radio"/>	<input type="radio"/>	<input type="radio"/>	<input type="radio"/>	<input type="radio"/>
Given the time available, the amount of material covered was appropriate.	<input type="radio"/>	<input type="radio"/>	<input type="radio"/>	<input type="radio"/>	<input type="radio"/>
Overall, I am satisfied with this session.	<input type="radio"/>	<input type="radio"/>	<input type="radio"/>	<input type="radio"/>	<input type="radio"/>
I would recommend this session to my colleagues.	<input type="radio"/>	<input type="radio"/>	<input type="radio"/>	<input type="radio"/>	<input type="radio"/>
The presenter(s) knowledge of the subject was apparent.	<input type="radio"/>	<input type="radio"/>	<input type="radio"/>	<input type="radio"/>	<input type="radio"/>
The presenter(s) presented the material in an organized way.	<input type="radio"/>	<input type="radio"/>	<input type="radio"/>	<input type="radio"/>	<input type="radio"/>
The handouts/materials I received were useful.	<input type="radio"/>	<input type="radio"/>	<input type="radio"/>	<input type="radio"/>	<input type="radio"/>
Appropriate audiovisuals were used during the presentation.	<input type="radio"/>	<input type="radio"/>	<input type="radio"/>	<input type="radio"/>	<input type="radio"/>
I would strongly recommend the presenter to be invited to conduct this session again.	<input type="radio"/>	<input type="radio"/>	<input type="radio"/>	<input type="radio"/>	<input type="radio"/>

Notes \_\_\_\_\_

---



---



---



---



---



---



---



---

# IMPORTANT Dates

## May 2014

S	M	T	W	T	F	S
					1	2 3
4	5	6	7	8	9	10
11	12	13	14	15	16	17
18	19	20	21	22	23	24
25	26	27	28	29	30	31

## June 2014

S	M	T	W	T	F	S
1	2	3	4	5	6	7
8	9	10	11	12	13	14
15	16	17	18	19	20	21
22	23	24	25	26	27	28
29	30					

## July 2014

S	M	T	W	T	F	S
		1	2	3	4	5
6	7	8	9	10	11	12
13	14	15	16	17	18	19
20	21	22	23	24	25	26
27	28	29	30	31		

## August 2014

S	M	T	W	T	F	S
						1 2
3	4	5	6	7	8	9
10	11	12	13	14	15	16
17	18	19	20	21	22	23
24	25	26	27	28	29	30
31						

## September 2014

S	M	T	W	T	F	S
1	2	3	4	5	6	
7	8	9	10	11	12	13
14	15	16	17	18	19	20
21	22	23	24	25	26	27
28	29	30				

## October 2014

S	M	T	W	T	F	S
						1 2 3 4
5	6	7	8	9	10	11
12	13	14	15	16	17	18
19	20	21	22	23	24	25
26	27	28	29	30	31	

## November 2014

S	M	T	W	T	F	S
						1
2	3	4	5	6	7	8
9	10	11	12	13	14	15
16	17	18	19	20	21	22
23	24	25	26	27	28	29
30						

## December 2014

S	M	T	W	T	F	S
1	2	3	4	5	6	
7	8	9	10	11	12	13
14	15	16	17	18	19	20
21	22	23	24	25	26	27
28	29	30	31			

## January 2015

S	M	T	W	T	F	S
					1	2 3
4	5	6	7	8	9	10
11	12	13	14	15	16	17
18	19	20	21	22	23	24
25	26	27	28	29	30	31

## February 2015

S	M	T	W	T	F	S
1	2	3	4	5	6	7
8	9	10	11	12	13	14
15	16	17	18	19	20	21
22	23	24	25	26	27	28
29	30					

## March 2015

S	M	T	W	T	F	S
1	2	3	4	5	6	7
8	9	10	11	12	13	14
15	16	17	18	19	20	21
22	23	24	25	26	27	28
29	30	31				

## April 2015

S	M	T	W	T	F	S
						1 2 3 4
5	6	7	8	9	10	11
12	13	14	15	16	17	18
19	20	21	22	23	24	25
26	27	28	29	30		

Date	Deadline
July 1, 2014	Call for presentations begins.
September 1, 2014	Call for presentations deadline.
December 1, 2014	Sponsor confirmations due to ensure logo is advertised in PIEPC advertising brochure.
December 8, 2014	<i>Early Bird Registration</i> begins for 2015 PIEPC.
February 28, 2015	<i>Early Bird Registration</i> ends for 2015 PIEPC.
March 1–April 14, 2015	Regular attendee conference price applies.
March 16, 2015	Conference Program goes to print (exhibitor and sponsor contracts due for company listing and printing in program).
April 14–16, 2015	Partners in Emergency Preparedness 2015 Conference

# **PARTNERS** **IN EMERGENCY** **PREPAREDNESS** **CONFERENCE 2015**

*Save the Date!*

**APRIL 14 – 16, 2015**  
**THE GREATER TACOMA**  
**CONVENTION & TRADE CENTER**  
**TACOMA, WASHINGTON**

**WWW.PIEPC.ORG**

# Thank You to **Our 2014 Sponsors**



## WITT | O'BRIEN'S

Seattle  
 Public  
Utilities



*PUGET  
SOUND  
ENERGY*

Northeastern University  
Seattle

PREMERA | 

**BLUE CROSS**

An Independent Licensee of the Blue Cross Blue Shield Association



 **TAKOUBA**  
READINESS | RESPONSE | RECOVERY



Washington Military Department

Emergency Management Division